

# MODEL DC-332.C DRIVE

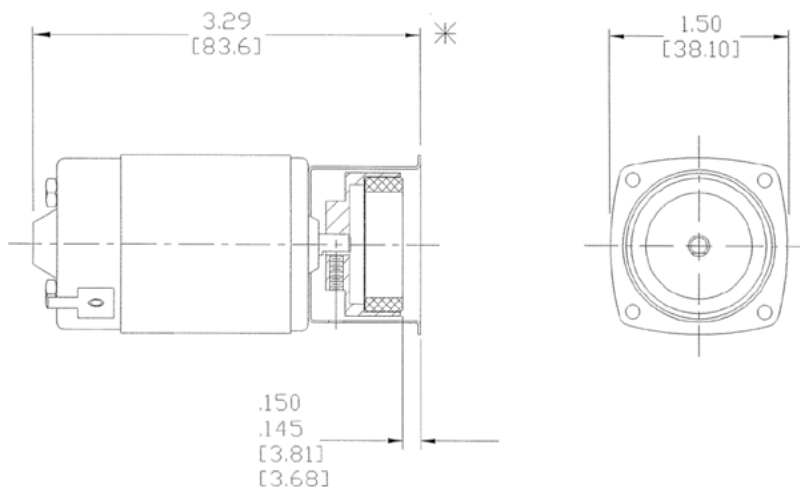

## AVERAGE TESTED PERFORMANCE

Speed vs. Torque

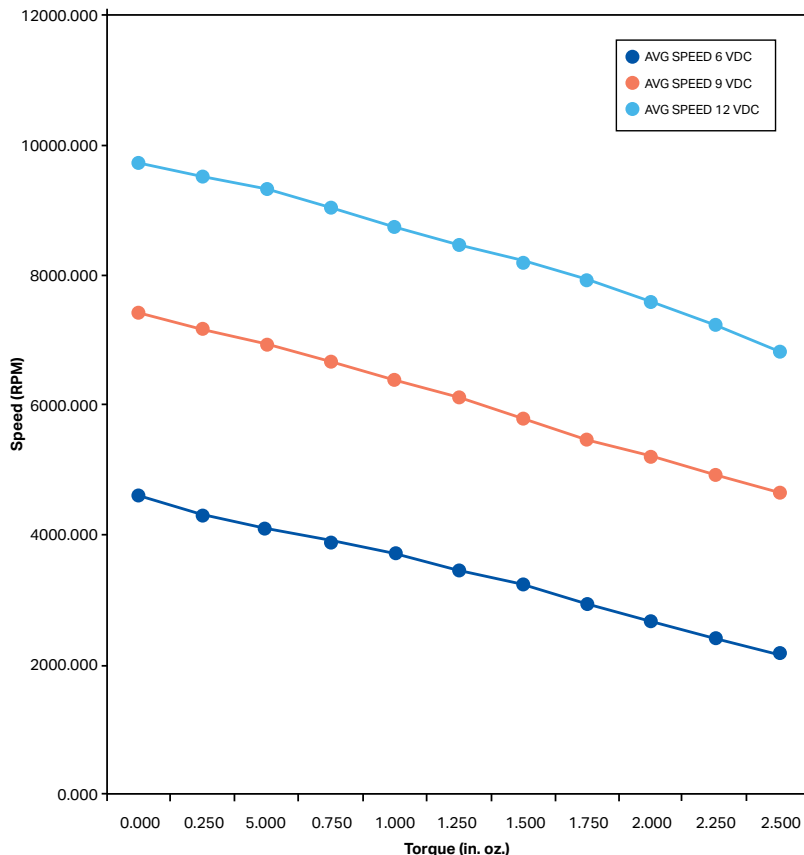

## MOTOR SPECIFICATIONS

### TYPE

- Permanent Magnet

### VOLTAGE

- 24 VDC

### AMPERAGE

- .20 AMPS Maximum at no load; 5.75 AMPS Maximum at stall.

### NO LOAD SPEED

- 7350 RPM Minimum

### TORQUE

- 14.5 OZ. IN. Minimum at stall.

### BEARING SLEEVE, ENDPLAY

- .015 MAX.

- Shaft rotation is CW Looking at Mounting with (+) on #1 Terminal.

- Male Spade Terminals, Tin plated

## WIRING CONNECTIONS

24 VDC	
<p>(+) MOTOR (-) C.W.S.E. (SHAFT END SHOWN)</p>	<p>Motor is labeled with (+) for positive</p> <p>TERMINALS ■ .188 Male Spade</p>

**MICROPUMP**