



EAGLEDRIVE™

The EagleDrive™ is an electromagnetic drive for Micropump GA, GB, GJ, GJR, GAF, and CA Series pumps. This compact, high-performance drive enables our pumps to address a wide range of applications.

The EagleDrive™ is an innovative brushless DC motor with no moving parts for outstanding efficiency and reliability. With variable speed operation, a tachometer and error output, and with fwd/rev capabilities, the EagleDrive™ is the right choice for many system designs.

MAGNETIC DRIVE GEAR PUMP

SMALL PACKAGE

The small package size means the EagleDrive™ is easily integrated into system designs.

HIGH TORQUE

High Torque offers improved flow rates with continuous duty pressures.

HIGHER PUMP SPEEDS

Pump speeds up to 8000 rpm resulting in higher flow rates.

DIGITAL ERROR OUTPUTS

Digital error outputs enable "check engine light" like diagnostic functionality.

ELECTROMAGNETIC DRIVE FEATURES

EASY DESIGN INTEGRATION

Supports wide range of power supply voltages (10-38V).
Error signals for easy error detection and diagnosis.

HIGH PERFORMANCE

Electromagnetic drive, with low inertia and high torque, for fast response times
Automotive grade electrical components for high temperature operation (up to 120°C) and durability.

LONG LIFE

Electromagnetic drive means fewer moving parts.

EAGLEDRIVE™

DEMSE



EAGLEDRIVE™ DEMSE

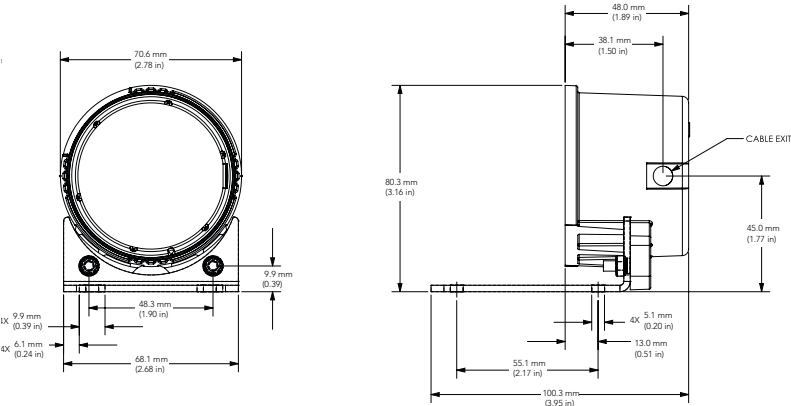

DEMSE DRIVE SPECIFICATIONS

SELECTABLE FEATURES

- Forward-Reverse Selection

TACHOMETER OUTPUT

- 2 PPR

FAULT OUTPUTS

- Over-Temp, Under-Voltage, or Internal Fault

POWER SUPPLY

- 10V to 38V DC

TEMPERATURE RANGE

- -40 to 120°C (-40 to 248°F)
- Max 85°C at Max Power

SPEED RANGE

- 36V = 1000 to 8000 rpm
- 24V = 500 to 5500 rpm
- 12V = 250 to 2650 rpm

TORQUE AT RATED SPEED

- 10 oz-in @ 3750 RPM (24V) (DEMSE)

CURRENT AT RATED TORQUE

- 2A @ 10 oz-in (24V) (DEMSE)

ENCLOSURE

- DEMSE Envelope Size (LxW): 2.8 x 1.9 in
- DEMSE Weight: < 10.6 oz (< 300 grams)

REGULATORY BODY COMPLIANCE

- RoHS

EAGLEDRIVE™ PUMP CONFIGURATIONS

EAGLEDRIVE™ DEMSE



GA Series



GJR Series



GJ Series



GAF Series



CA Series

EAGLEDRIVE™ DEELE



EAGLEDRIVE™ DEELE

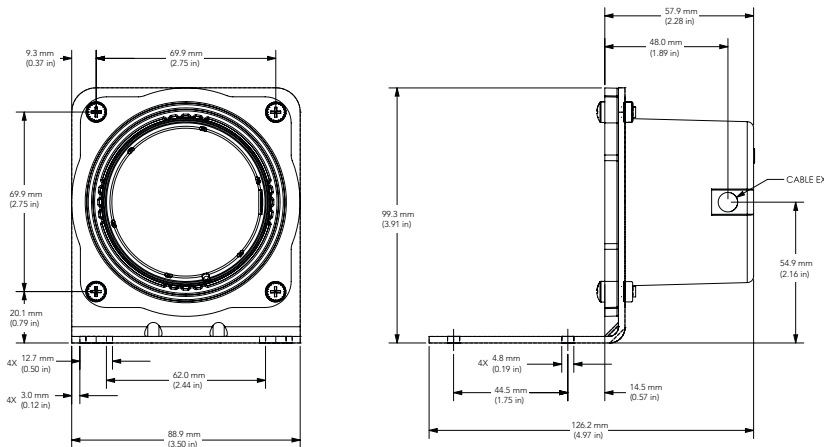

DEELE DRIVE SPECIFICATIONS

- SELECTABLE FEATURES**
 - Forward-Reverse Selection
- TACHOMETER OUTPUT**
 - 2 PPR
- FAULT OUTPUTS**
 - Over-Temp, Under-Voltage, or Internal Fault
- POWER SUPPLY**
 - 10V to 38V DC
- TEMPERATURE RANGE**
 - 40 to 120°C (-40 to 248°F)
 - Max 85°C at Max Power

- SPEED RANGE**
 - 36V = 1000 to 8000 rpm
 - 24V = 500 to 5500 rpm
 - 12V = 250 to 2650 rpm

- TORQUE AT RATED SPEED**
 - 20 oz-in @ 3750 RPM (24V) (DEELE)

- CURRENT AT RATED TORQUE**
 - 2.9A @ 20 oz-in (24V) (DEELE)

- ENCLOSURE**
 - DEELE Envelope Size (LxW): 2.8 x 2.3 in
 - DEELE Weight: < 17.6 oz (< 500 grams)

- REGULATORY BODY COMPLIANCE**
 - RoHS

EAGLEDRIVE™ PUMP CONFIGURATIONS

EAGLEDRIVE™ DEELE

