

Series GMH

Magnetic Drive Gear Pump

MICROPUMP®

Order Code

Base Code		Gear Set		Drive Mount		Options	
G	MH						
1	2	3	4	5	6	7	8
Model				Wetted Materials		O/C: Pump S/K: Service Kit	

Pump Construction

Magnetic Drive Gear Pump
Cavity Style
Two Helical, Shafted Gears/DP10
Sleeve Bushings
O-Ring Seals (Qty 3)
Rare Earth Magnets



BASE	CODE	SPECIFICATIONS			
1	G	Product Type Gear Pump			
2	MH	Product Series Series GMH	Max System Pressure (MAWP) 103 Bar (1500 psi)	Ports 3/4-14 (F) NPT Side Ports	
3		Modifier High System Pressure			
4	G25	Gear Set (Width/N°Gears/Pitch) 1.250/2/10	Displacement 12.2 ml/rev (3.2 gal/1000*rev)	Max Differential Pressure 8.7 Bar (125 psi)	Driven Magnet (Standard) Samarium Cobalt (SmCo)
5	J	Gear Material PEEK (carbon fiber/ptfe)		Max Differential Pressure 8.7 Bar (125 psi)	Temp Range -46/121°C (-50/250°F)
6	V F5	Static Seals Viton® TEV (PTFE encap Viton®)			Temp Range -29/204°C (-20/400°F) -29/204°C (-20/400°F)
7	S10	Base Materials SS316 and Titanium			
8	E 8	Drive Mount NEMA 56C/143/145TC IEC 80-B14	Max System Pressure (MAWP) 103 Bar (1500 psi) 103 Bar (1500 psi)		Weight (Pumphead) 10.9 kg (24.0 lbs) 10.9 kg (24.0 lbs)

Performance

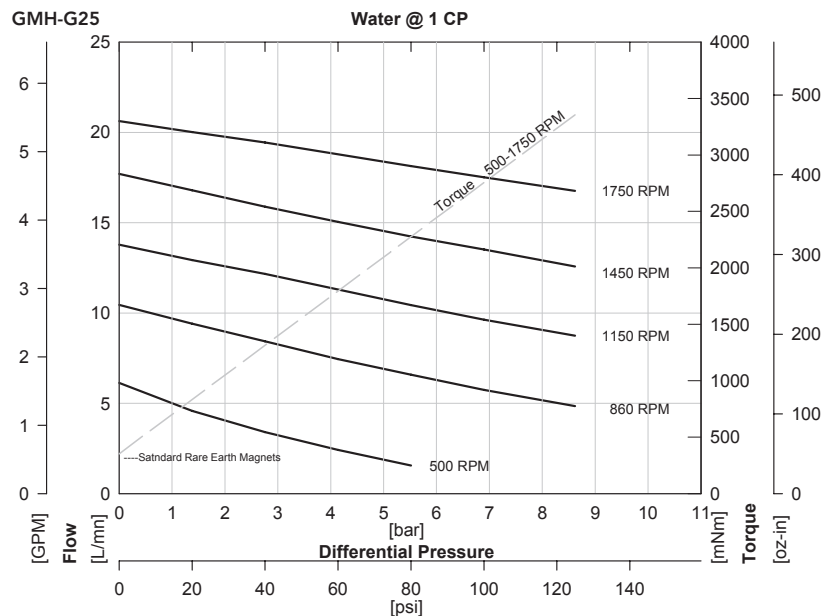

Order Code

Base Code		Gear Set		Drive Mount		Options	
G	MH		G25				
1	2	3	4	5	6	7	8
Model			Wetted Materials			O/C: Pump S/K: Service Kit	

Performance – High Viscosity

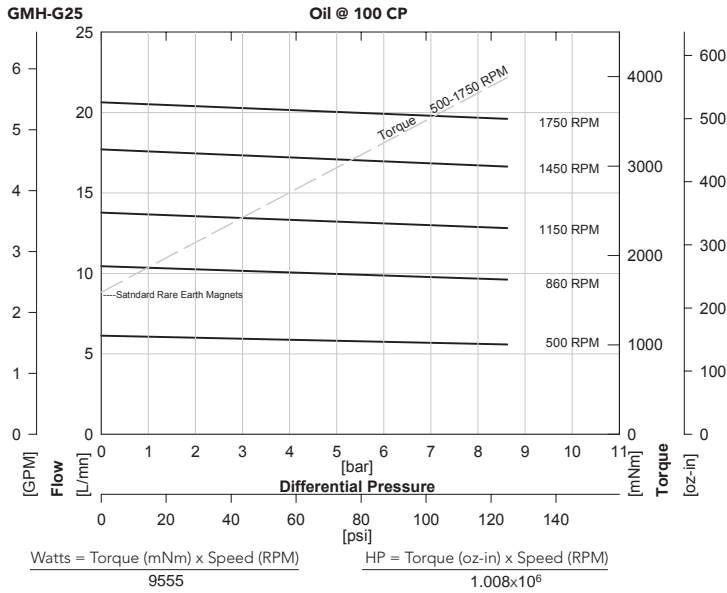

To calculate torque, multiply correction factor by torque from viscosity curve above.

Torque Correction Factors: For Higher Viscosity Liquids

Viscosity (cp) Max Speed [RPM]		1 1750	100 1750	2500 1750
[Bar]	[psi]			
0.3	5	0.2	1	3.0
1.4	20	0.4	1	2.6
2.8	40	0.6	1	2.2
4.1	60	0.7	1	
5.5	80	0.8	1	
6.9	100	0.8	1	

Magnet Decouple Torque

Driven Magnet	Driving Hub Torque	[mNm]	[oz.in]
SmCo	SmCo	5650	800

Pump Construction

Magnetic Drive Gear Pump
Cavity Style
Two Helical, Shafted Gears/DP10
Sleeve Bushings
O-Ring Seals (Qty 3)
Rare Earth Magnets



Specifications

	SI	US
Displacement	12.2 ml/rev	3.2 gal/1000*rev
Max Flow (4 Pole Speed)	17.7 L/mn 1450 RPM (50Hz)	5.7 gal/mn 1750 RPM (60Hz)
Max Differential Pressure	1 8.7 Bar	125 psi
Max System Pressure (MAWP)	See Drive Mount	See Drive Mount
NIPR (Absolute)	180 mBar	2.5 psia
Wet Lift (Typical)	2 51 cm.H ₂ O (1450 RPM)	24 in.H ₂ O (1750 RPM)
Temp Range	3 See Gear Material	See Gear Material
Viscosity Range	4 0.2 to 2500 cp	0.2 to 2500 cp
Max Speed	1,750 RPM	1,750 RPM
Rotation (Facing Motor Shaft)	CW	CW
Weight (Pumphead)	10.9 kg	24.0 lbs
Dimensions (LxWxH)	See Drawing	See Drawing
Ports	3/4-14 (F) NPT Side Ports	3/4-14 (F) NPT Side Ports
Driven Magnet (Standard)		
Optional Internal Bypass	No	No

Notes

- 1 Priming ability varies with operating conditions.
- 2 See Product Options for specific temp limits.
- 3 See Performance-High Viscosity for viscosity limits.

MICROPUMP

ACTUAL PERFORMANCE MAY VARY.

Specifications are subject to change without notice.

Micropump, and the Micropump logo are registered trademarks of Micropump, Inc.

PEEK polymer is a trademark of Victrex plc.

Viton is a registered trademark of E.I. du Pont de Nemours and Company.

MICROPUMP Inc.

4600 NW Camas Meadows Suite 202
Camas, WA 98607 USA
Tel. +1 360-253-2008

www.micropump.com
www.cemegroup.com

Avenida de la Eficiencia #167,
Nuevo Nogales Industrial Park,
Nogales, Sonora, C.P. 84094

Mda Business Park, Irishtown,
Mountmellick, Co. Laois, R32 XYK6, Ireland

VAT GB975036992

Mod. 01 del .../24



CEMIE ULKA

AC

MICROPUMP

PROCON

Order Code

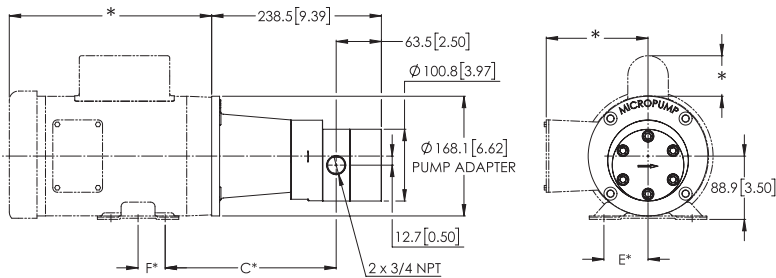
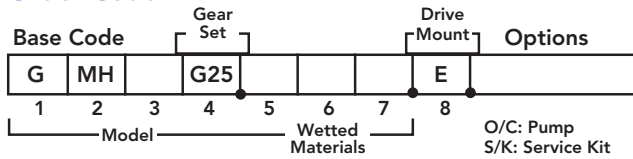

Mount	C mm (in)	E mm (in)	F mm (in)
E NEMA 56C	240.2 (9.46)	61.9 (2.44)	38.1 (1.50)
K NEMA 143TC	240.2 (9.46)	69.9 (2.75)	50.8 (2.00)
K NEMA 145TC	240.2 (9.46)	69.9 (2.75)	63.5 (2.50)

Order Code

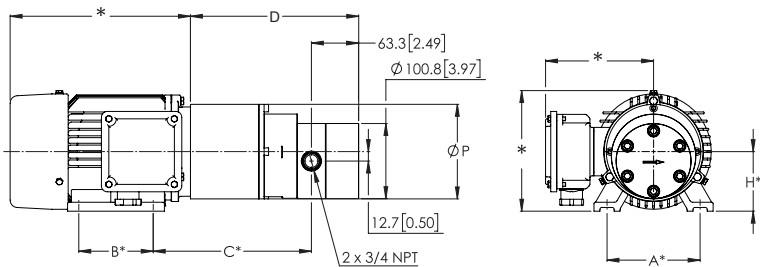
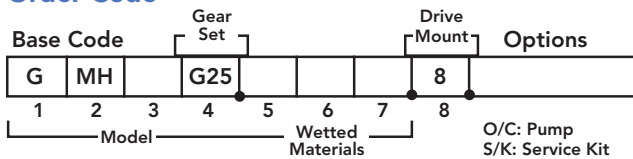

Notes

- * These dimensions are guidelines based on the standards and may vary based on the motor selection. Orientation of the junction box on the motor may also vary.
- All dimensions are nominal.

Mount	A mm (in)	B mm (in)	C mm (in)
8 IEC 80-B14	125.0 (4.92)	100.0 (3.94)	212.5 (8.37)
	D mm (in)	H mm (in)	P mm (in)
	226.0 (8.90)	80.0 (3.15)	127.0 (5.00)



MICROPUMP®

ACTUAL PERFORMANCE MAY VARY.

Specifications are subject to change without notice.

Micropump, and the Micropump logo are registered trademarks of Micropump, Inc.

PEEK polymer is a trademark of Victrex plc.

Viton is a registered trademark of E.I. du Pont de Nemours and Company.

MICROPUMP Inc.

4600 NW Camas Meadows Suite 200
Camas, WA 98607 USA
Tel. +1 360-253-2008

www.micropump.com
www.cemegroup.com

Avenida de la Eficiencia #167,
Nuevo Nogales Industrial Park,
Nogales, Sonora, C.P. 84094

Mda Business Park, Irishtown,
Mountmellick, Co. Laois, R32 XYK6, Ireland

VAT GB975036992

Mod. 01 del .././24

CEME ULKA

AC

MICROPUMP

PROCON