

<u>Order Code</u>										<u>Pump Construction</u>
Base Code		Gear Set			Drive Mount			Options		
G	B									
1	2	3	4	5	6	7	8			
Model		Wetted Materials			O/C: Pump S/K: Service Kit					
Magnetic Drive Gear Pump Suction Shoe Style Two or Three Helical Gears/DP25 Stationary Shafts O-Ring Seal (Qty 1)										

Base Code Select a code character for each numbered position to configure the product.

1	Code	Product Type	Specifications		Notes
	G	Gear Pump			
2	B	Series GB	Max System Pressure (MAWP)	Ports	
			21 Bar (300 psi)	1/8-27 (F) NPT Side Ports	
3	-	Modifier			
		Standard Design			
4		Gear Set (Width/N°Gears/Pitch)	Displacement	Max Differential Pressure	Driven Magnet (Standard)
	P23	0.150/2/25	0.261 ml/rev (0.07 gal/1000*rev)	8.7 Bar (125 psi)	Ferrite
	P25	0.350/2/25	0.58 ml/rev (0.15 gal/1000*rev)	8.7 Bar (125 psi)	Ferrite
	P35	0.350/3/25	1.17 ml/rev (0.31 gal/1000*rev)	4.2 Bar (60 psi)	Ferrite
5		Gear Material	Max Differential Pressure	Temp Range	
	P	PPS (carbon fiber/ptfe)	5.2 Bar (75 psi)	-46/177°C (-50/350°F)	
	J	PEEK (carbon fiber/ptfe)	8.7 Bar (125 psi)	-46/177°C (-50/350°F)	
6		Static Seals	Temp Range		
	V	Viton®	-29/204°C (-20/400°F)		
	D	EP	-46/149°C (-50/300°F)		
	F5	TEV (PTFE encap Viton®)	-29/204°C (-20/400°F)		
	K	Kalrez®	-29/260°C (-20/500°F)		
7		Base Materials			
	S	SS316			
	D	Alloy 20			
	T	Titanium			
	C	Hast C-276®			
8		Drive Mount	Max System Pressure (MAWP)	Weight (Pumphead)	
	A	MP Housing	21 Bar (300 psi)	0.34 kg (0.75 lbs)	
	SE	EagleDrive™ DEMSx	21 Bar(300 psi) SS316	0.37 kg (0.82 lbs)	
	LE	EagleDrive™ DEELx	21 Bar(300 psi) SS316	0.37 kg (0.82 lbs)	
	E	NEMA 56C/143/145TC	21 Bar (300 psi)	1.1 kg (2.4 lbs)	1
	2-6	IEC 56-B14 - IEC 71-B14	21 Bar (300 psi)	1.1 kg (2.4 lbs)	1

Options Add Option codes after the Base Code to modify features or enhance the product.

Bypass (PC11)		Optional Internal Bypass	
B1	Internal Bypass (SS316)	Preset to 3 Bar (pump only)	2
Driving Magnet (PC13)		Temp Range	
N0	Ferrite Driving (Ring)	-46/99°C (-50/210°F)	3
N1	SmCo Driving (Segments)	-46/260°C (-50/500°F)	3
N3	NdFeB Driving (Ring)	-46/82°C (-50/180°F)	3

Notes

- Using industrial IEC or NEMA Adapter Kits mounts
- Available in SS316 only
- Available only with industrial IEC or NEMA drive mounts

Order Code										Options	
Base Code			Gear Set			Drive Mount					
G	B	-	P23								
1	2	3	4	5	6	7	8				
Model			Wetted Materials								
O/C: Pump S/K: Service Kit											

Pump Construction	
Magnetic Drive Gear Pump	
Suction Shoe Style	
Two or Three Helical Gears/DP25	
Stationary Shafts	
O-Ring Seal (Qty 1)	



Pump Construction

Magnetic Drive Gear Pump
Suction Shoe Style
Two or Three Helical Gears/DP25
Stationary Shafts
O-Ring Seal (Qty 1)



Performance

GB-P23

Water @ 1 CP

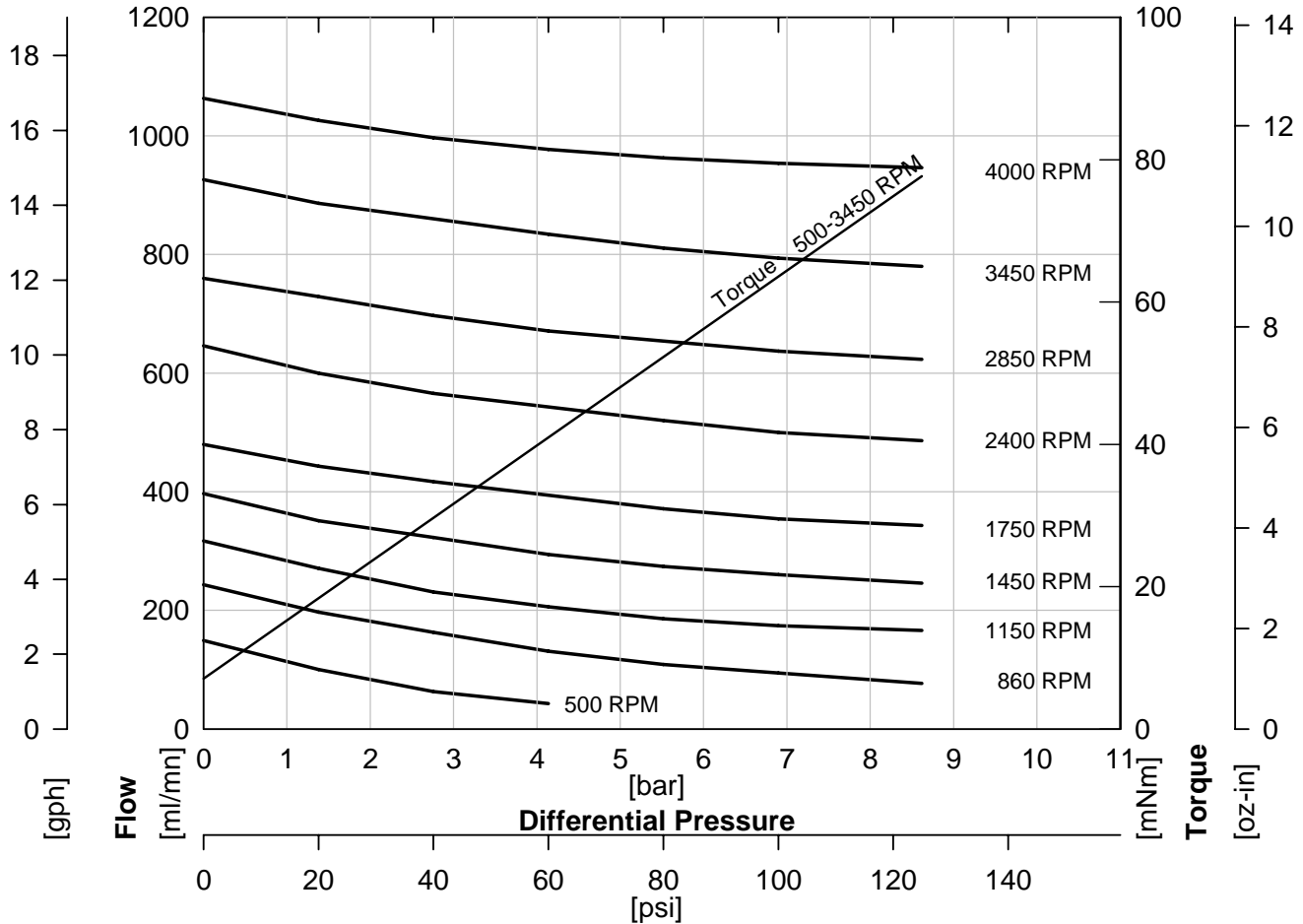

ACTUAL PERFORMANCE MAY VARY - Specifications are subject to change without notice. When multiple specs are noted, the most conservative value applies.

MICROPUMP Inc.

4600 NW Camas Meadows Suite 200
Camas, WA 98607 USA
Tel. +1 360-253-2008

www.micropump.com
www.cemegroup.com

Avenida de la Eficiencia #167,
Nuevo Nogales Industrial Park,
Nogales, Sonora, C.P. 84094

Mda Business Park, Irishtown,
Mountmellick, Co. Laois, R32 XYK6, Ireland

VAT GB975036992

Mod. 01 del ./. /24

CEME ULKA

AC

MICROPUMP

PROCON

Order Code				Pump Construction			
Base Code G B - P23 1 2 3 4 5 6 7 8 Model Wetted Materials				Magnetic Drive Gear Pump Suction Shoe Style Two or Three Helical Gears/DP25 Stationary Shafts O-Ring Seal (Qty 1)			
Options O/C: Pump S/K: Service Kit							

Performance-High Viscosity

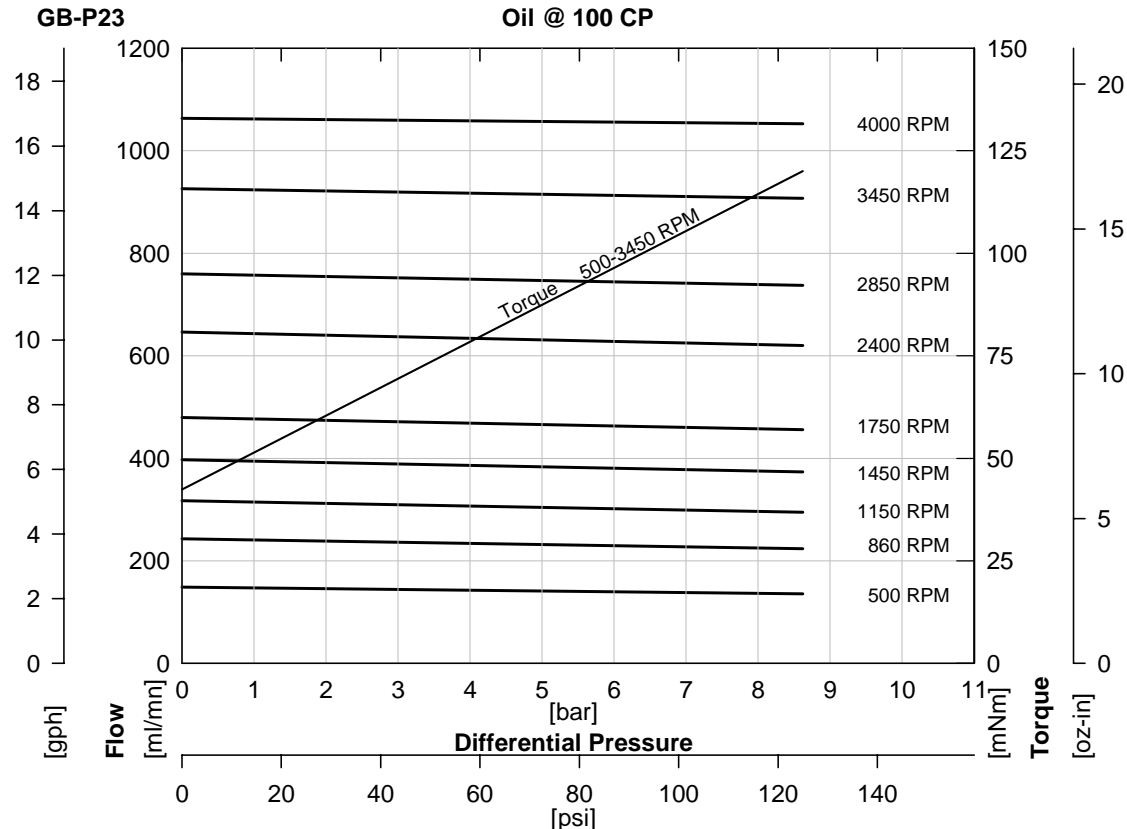

$$\text{Watts} = \frac{\text{Torque [mNm]} \times \text{Speed [RPM]}}{9555}$$

$$\text{HP} = \frac{\text{Torque [oz-in]} \times \text{Speed [RPM]}}{1.008 \times 10^6}$$

To calculate torque, multiply correction factor by torque from viscosity curve above.

Torque Correction Factors: For Higher Viscosity Liquids				
Viscosity [cp]		1	100	1500
Max Speed [RPM]		3450	3450	1450
[Bar]	[psi]			
0.3	5	0.2	1	2.7
1.4	20	0.3	1	2.3
2.8	40	0.4	1	2.1
4.1	60	0.5	1	1.9
5.5	80	0.6	1	1.7
6.9	100	0.6	1	1.6
8.6	125	0.6	1	1.5

Magnet Decouple Torque			
Driven Magnet	Driving Hub	Torque [mNm]	Torque [oz.in]
Ferrite	Ferrite	155	22
Ferrite	SmCo	212	30
Ferrite	NdFeB	353	50
SmCo	Ferrite	254	36
SmCo	SmCo	565	80
SmCo	NdFeB	777	110

ACTUAL PERFORMANCE MAY VARY - Specifications are subject to change without notice. When multiple specs are noted, the most conservative value applies.

<u>Order Code</u>								<u>Pump Construction</u>			
Base Code			Gear Set		Drive Mount			Options			Magnetic Drive Gear Pump
G	B	-	P23								Suction Shoe Style
1	2	3	4	5	6	7	8				Two or Three Helical Gears/DP25
Model			Wetted Materials								Stationary Shafts
										O-Ring Seal (Qty 1)	

Pump Construction

Magnetic Drive Gear Pump
Suction Shoe Style
Two or Three Helical Gears/DP25
Stationary Shafts
O-Ring Seal (Qty 1)

Specifications

	SI	US
Displacement	0.261 ml/rev	0.07 gal/1000*rev
Max Flow (4 Pole Speed)	380 ml/mn 1450 RPM (50Hz)	7.3 gal/hr 1750 RPM (60Hz)
Max Flow (2 Pole Speed)	750 ml/mn 2850 RPM (50Hz)	15 gal/hr 3450 RPM (60Hz)
Max Differential Pressure	1 8.7 Bar	125 psi
Max System Pressure (MAWP)	21 Bar	300 psi
NIPR (Absolute)	180 mBar	2.5 psia
Wet Lift (Typical)	2 51 cm.H2O (1450 RPM)	24 in.H2O (1750 RPM)
Temp Range	3 See Gear Material	See Gear Material
Viscosity Range	4 0.2 to 1500 cp	0.2 to 1500 cp
Max Speed	10,000 RPM	10,000 RPM
Rotation (Facing Motor Shaft)	CW	CW
Weight (Pumphead)	0.34 kg	0.75 lbs
Dimensions (LxWxH)	See Drawing	See Drawing
Ports	1/8-27 (F) NPT Side Ports	1/8-27 (F) NPT Side Ports
Driven Magnet (Standard)	Ferrite	Ferrite
Optional Internal Bypass	Preset to 3 Bar (pump only)	Preset to 45 psi (pump only)

Notes

- See Product Options. Max pressure depends on gear material.
- Priming ability varies with operating conditions.
- See Product Options for specific temp limits.
- See Performance-High Viscosity for viscosity limits.

ACTUAL PERFORMANCE MAY VARY - Specifications are subject to change without notice. When multiple specs are noted, the most conservative value applies.

MICROPUMP Inc.

4600 NW Camas Meadows Suite 200
Camas, WA 98607 USA
Tel. +1 360-253-2008

www.micropump.com
www.cemegroup.com

Avenida de la Eficiencia #167,
Nuevo Nogales Industrial Park,
Nogales, Sonora, C.P. 84094

Mda Business Park, Irishtown,
Mountmellick, Co. Laois, R32 XYK6, Ireland

VAT GB975036992

Mod. 01 del ././24

CEME ULKA

AC

MICROPUMP

PROCON

Order Code										Options		
Base Code			Gear Set		Drive Mount							
G	B	-	P23				2/4/6					
1	2	3	4	5	6	7	8					
Model			Wetted Materials						O/C: Pump S/K: Service Kit			

Pump Construction	
Magnetic Drive Gear Pump	
Suction Shoe Style	
Two or Three Helical Gears/DP25	
Stationary Shafts	
O-Ring Seal (Qty 1)	

Pump Construction

Magnetic Drive Gear Pump
Suction Shoe Style
Two or Three Helical Gears/DP25
Stationary Shafts
O-Ring Seal (Qty 1)

Dimensions

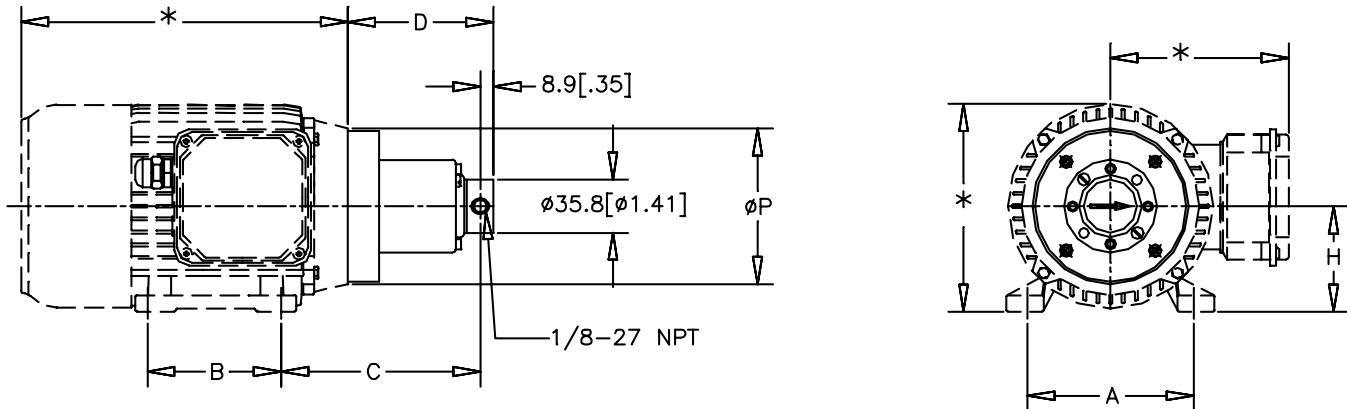

MOUNT	A mm [in]	B mm [in]	C mm [in]	D mm [in]	H mm [in]	P mm [in]
2 IEC56B14B3	90 [3.54]	71 [2.80]	112.4 [4.43]	85.3 [3.36]	56 [2.20]	80 [3.15]
4 IEC63B14B3	100 [3.94]	80 [3.15]	122.0 [4.80]	90.9 [3.58]	63 [2.48]	90 [3.54]
6 IEC71B14B3	112 [4.41]	90 [3.54]	134.1 [5.28]	97.9 [3.86]	71 [2.80]	105 [4.13]

NOTES:

- *THESE DIMENSIONS WILL VARY BASED ON MOTOR SELECTION.
- ALL DIMENSIONS ARE NOMINAL.

ACTUAL PERFORMANCE MAY VARY - Specifications are subject to change without notice. When multiple specs are noted, the most conservative value applies.

MICROPUMP Inc.

4600 NW Camas Meadows Suite 200
Camas, WA 98607 USA
Tel. +1 360-253-2008

www.micropump.com
www.cemegroup.com

Avenida de la Eficiencia #167,
Nuevo Nogales Industrial Park,
Nogales, Sonora, C.P. 84094

Mda Business Park, Irishtown,
Mountmellick, Co. Laois, R32 XYK6, Ireland

VAT GB975036992

Mod. 01 del ./././24

CEME ULKA

AC

MICROPUMP

PROCON

Order Code										Options			
Base Code			Gear Set		Drive Mount								
G	B	-	P23				A						
1	2	3	4	5	6	7	8						
Model			Wetted Materials					O/C: Pump S/K: Service Kit					

Pump Construction	
Magnetic Drive Gear Pump	
Suction Shoe Style	
Two or Three Helical Gears/DP25	
Stationary Shafts	
O-Ring Seal (Qty 1)	

Pump Construction

Magnetic Drive Gear Pump
Suction Shoe Style
Two or Three Helical Gears/DP25
Stationary Shafts
O-Ring Seal (Qty 1)

Dimensions

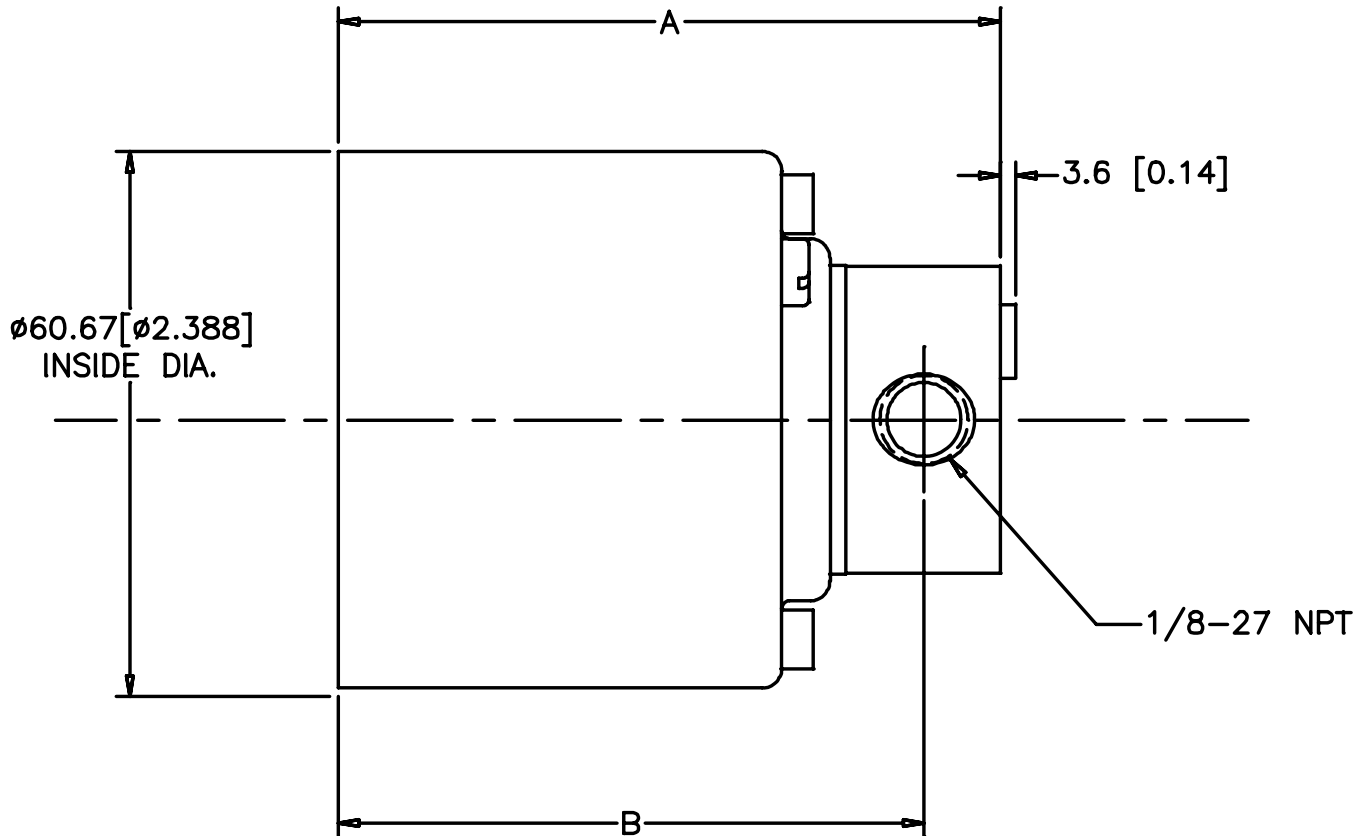

A (MAX) mm [in]	B mm [in]
77.0 [3.03]	68.1 [2.68]

NOTES:

1. ALL DIMENSIONS ARE NOMINAL.

ACTUAL PERFORMANCE MAY VARY - Specifications are subject to change without notice. When multiple specs are noted, the most conservative value applies.

MICROPUMP Inc.

4600 NW Camas Meadows Suite 200
Camas, WA 98607 USA
Tel. +1 360-253-2008

www.micropump.com
www.cemegroup.com

Avenida de la Eficiencia #167,
Nuevo Nogales Industrial Park,
Nogales, Sonora, C.P. 84094

Mda Business Park, Irishtown,
Mountmellick, Co. Laois, R32 XYK6, Ireland

VAT GB975036992

Mod. 01 del ./././24

CETE ULKA

AC

MICROPUMP
PROCON

Order Code										Pump Construction
Base Code				Gear Set		Drive Mount		Options		
G	B	-	P23				E			
1	2	3	4	5	6	7	8			
Model			Wetted Materials					O/C: Pump S/K: Service Kit		
<p>Magnetic Drive Gear Pump Suction Shoe Style Two or Three Helical Gears/DP25 Stationary Shafts O-Ring Seal (Qty 1)</p>										

Pump Construction
 Magnetic Drive Gear Pump
 Suction Shoe Style
 Two or Three Helical Gears/DP25
 Stationary Shafts
 O-Ring Seal (Qty 1)



Dimensions

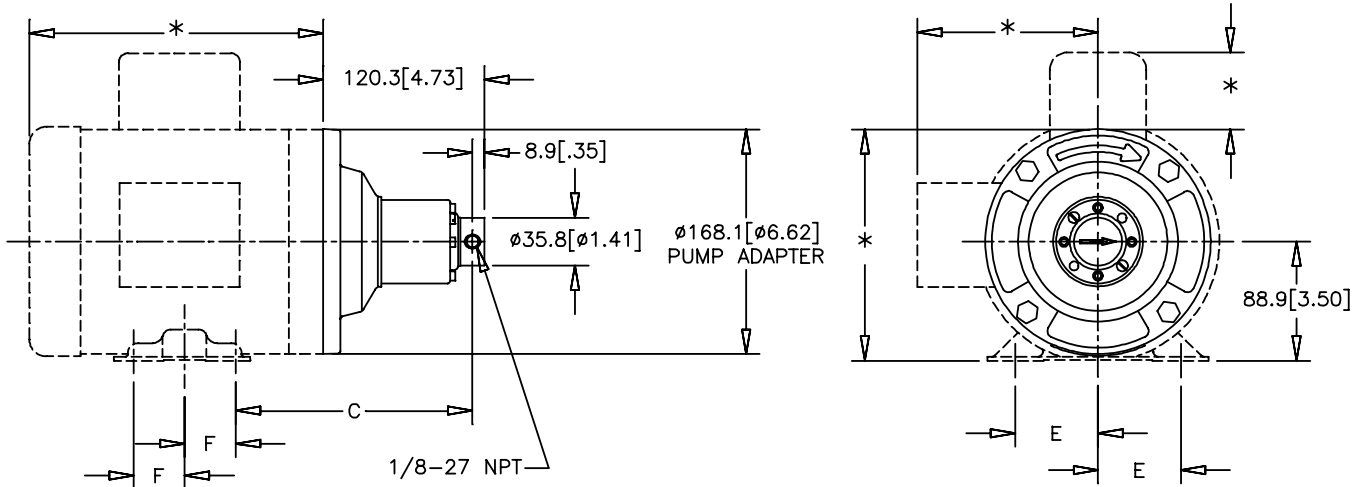

MOUNT	C mm [in]	E mm [in]	F mm [in]
NEMA ^E 56C	176.7 [6.95]	61.9 [2.44]	38.1 [1.50]
NEMA ^K 143TC	171.8 [6.77]	69.9 [2.75]	50.8 [2.00]
NEMA ^K 145TC	171.8 [6.77]	69.9 [2.75]	63.5 [2.50]

NOTES:

- *THESE DIMENSIONS WILL VARY BASED ON MOTOR SELECTION.
- ALL DIMENSIONS ARE NOMINAL.

ACTUAL PERFORMANCE MAY VARY - Specifications are subject to change without notice. When multiple specs are noted, the most conservative value applies.

Order Code										Options	
Base Code			Gear Set		Drive Mount						
G	B	-	P25								
1	2	3	4	5	6	7	8				
Model			Wetted Materials								
										O/C: Pump S/K: Service Kit	

Pump Construction	
Magnetic Drive Gear Pump	
Suction Shoe Style	
Two or Three Helical Gears/DP25	
Stationary Shafts	
O-Ring Seal (Qty 1)	



Pump Construction

Magnetic Drive Gear Pump
Suction Shoe Style
Two or Three Helical Gears/DP25
Stationary Shafts
O-Ring Seal (Qty 1)



Performance

GB-P25

Water @ 1 CP

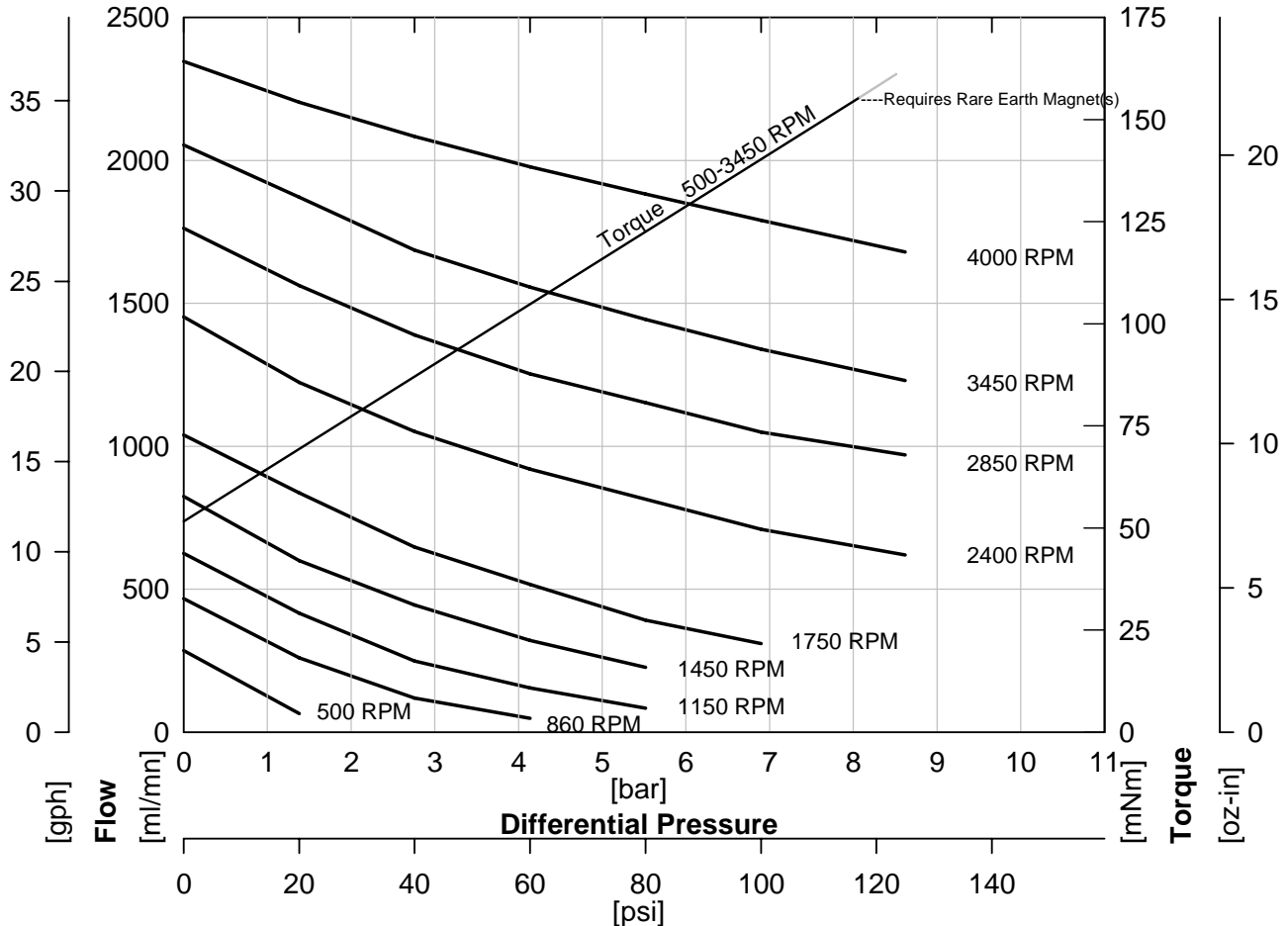

ACTUAL PERFORMANCE MAY VARY - Specifications are subject to change without notice. When multiple specs are noted, the most conservative value applies.

MICROPUMP Inc.

4600 NW Camas Meadows Suite 200
Camas, WA 98607 USA
Tel. +1 360-253-2008

www.micropump.com
www.cemegroup.com

Avenida de la Eficiencia #167,
Nuevo Nogales Industrial Park,
Nogales, Sonora, C.P. 84094

Mda Business Park, Irishtown,
Mountmellick, Co. Laois, R32 XYK6, Ireland

VAT GB975036992

Mod. 01 del ./. /24

CEME ULKA

AC

MICROPUMP

PROCON

Order Code				Pump Construction																			
Base Code <table border="1"> <tr> <td>G</td> <td>B</td> <td>-</td> <td>P25</td> </tr> <tr> <td>1</td> <td>2</td> <td>3</td> <td>4</td> </tr> </table>				G	B	-	P25	1	2	3	4	Options <table border="1"> <tr> <td colspan="4">Wetted Materials</td> </tr> <tr> <td colspan="4">O/C: Pump S/K: Service Kit</td> </tr> </table>				Wetted Materials				O/C: Pump S/K: Service Kit			
G	B	-	P25																				
1	2	3	4																				
Wetted Materials																							
O/C: Pump S/K: Service Kit																							
Gear Set <table border="1"> <tr> <td>5</td> <td>6</td> <td>7</td> <td>8</td> </tr> </table>				5	6	7	8	Drive Mount <table border="1"> <tr> <td colspan="4"></td> </tr> </table>															
5	6	7	8																				



Performance-High Viscosity

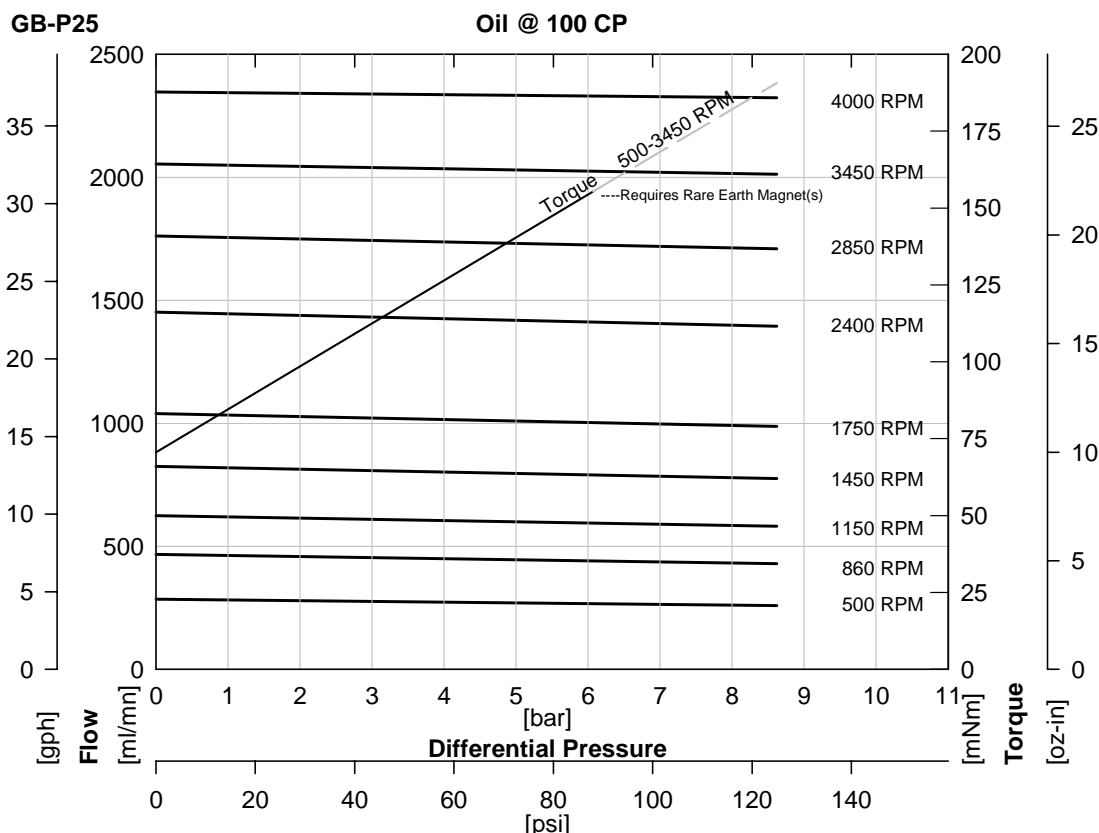

$$\text{Watts} = \frac{\text{Torque [mNm]} \times \text{Speed [RPM]}}{9555}$$

$$\text{HP} = \frac{\text{Torque [oz-in]} \times \text{Speed [RPM]}}{1.008 \times 10^6}$$

To calculate torque, multiply correction factor by torque from viscosity curve above.

Torque Correction Factors: For Higher Viscosity Liquids				
Viscosity [cp]		1	100	1500
Max Speed [RPM]		3450	3450	1150
[Bar]	[psi]			
0.3	5	0.7	1	2.1
1.4	20	0.8	1	1.9
2.8	40	0.8	1	1.7
4.1	60	0.8	1	1.9
5.5	80	0.8	1	1.4
6.9	100	0.8	1	1.3
8.6	125	0.9	1	1.3

Magnet Decouple Torque			
Driven Magnet	Driving Hub	Torque [mNm]	Torque [oz.in]
Ferrite	Ferrite	155	22
Ferrite	SmCo	212	30
Ferrite	NdFeB	353	50
SmCo	Ferrite	254	36
SmCo	SmCo	565	80
SmCo	NdFeB	777	110

ACTUAL PERFORMANCE MAY VARY - Specifications are subject to change without notice. When multiple specs are noted, the most conservative value applies.

Order Code										Pump Construction
Base Code				Gear Set		Drive Mount		Options		
G	B	-	P25							
1	2	3	4	5	6	7	8			
Model			Wetted Materials			O/C: Pump S/K: Service Kit				

Pump Construction
 Magnetic Drive Gear Pump
 Suction Shoe Style
 Two or Three Helical Gears/DP25
 Stationary Shafts
 O-Ring Seal (Qty 1)

Specifications

	SI	US
Displacement	0.58 ml/rev	0.15 gal/1000*rev
Max Flow (4 Pole Speed)	850 ml/mn 1450 RPM (50Hz)	17 gal/hr 1750 RPM (60Hz)
Max Flow (2 Pole Speed)	1660 ml/mn 2850 RPM (50Hz)	32 gal/hr 3450 RPM (60Hz)
Max Differential Pressure	1 8.7 Bar	125 psi
Max System Pressure (MAWP)	21 Bar	300 psi
NIPR (Absolute)	180 mBar	2.5 psia
Wet Lift (Typical)	2 51 cm.H2O (1450 RPM)	24 in.H2O (1750 RPM)
Temp Range	3 See Gear Material	See Gear Material
Viscosity Range	4 0.2 to 1500 cp	0.2 to 1500 cp
Max Speed	10,000 RPM	10,000 RPM
Rotation (Facing Motor Shaft)	CW	CW
Weight (Pumphead)	0.34 kg	0.75 lbs
Dimensions (LxWxH)	See Drawing	See Drawing
Ports	1/8-27 (F) NPT Side Ports	1/8-27 (F) NPT Side Ports
Driven Magnet (Standard)	Ferrite	Ferrite
Optional Internal Bypass	Preset to 3 Bar (pump only)	Preset to 45 psi (pump only)

Notes

- See Product Options. Max pressure depends on gear material.
- Priming ability varies with operating conditions.
- See Product Options for specific temp limits.
- See Performance-High Viscosity for viscosity limits.

ACTUAL PERFORMANCE MAY VARY - Specifications are subject to change without notice. When multiple specs are noted, the most conservative value applies.

MICROPUMP Inc.

4600 NW Camas Meadows Suite 200
Camas, WA 98607 USA
Tel. +1 360-253-2008

www.micropump.com
www.cemegroup.com

Avenida de la Eficiencia #167,
Nuevo Nogales Industrial Park,
Nogales, Sonora, C.P. 84094

Mda Business Park, Irishtown,
Mountmellick, Co. Laois, R32 XYK6, Ireland

VAT GB975036992

Mod. 01 del ././24

CEME ULKA

AC

MICROPUMP
PROCON

Order Code										Options			
Base Code			Gear Set		Drive Mount								
G	B	-	P25				2/4/6						
1	2	3	4	5	6	7	8						
Model			Wetted Materials					O/C: Pump S/K: Service Kit					

Pump Construction	
Magnetic Drive Gear Pump	
Suction Shoe Style	
Two or Three Helical Gears/DP25	
Stationary Shafts	
O-Ring Seal (Qty 1)	

Pump Construction

Magnetic Drive Gear Pump
Suction Shoe Style
Two or Three Helical Gears/DP25
Stationary Shafts
O-Ring Seal (Qty 1)

Dimensions

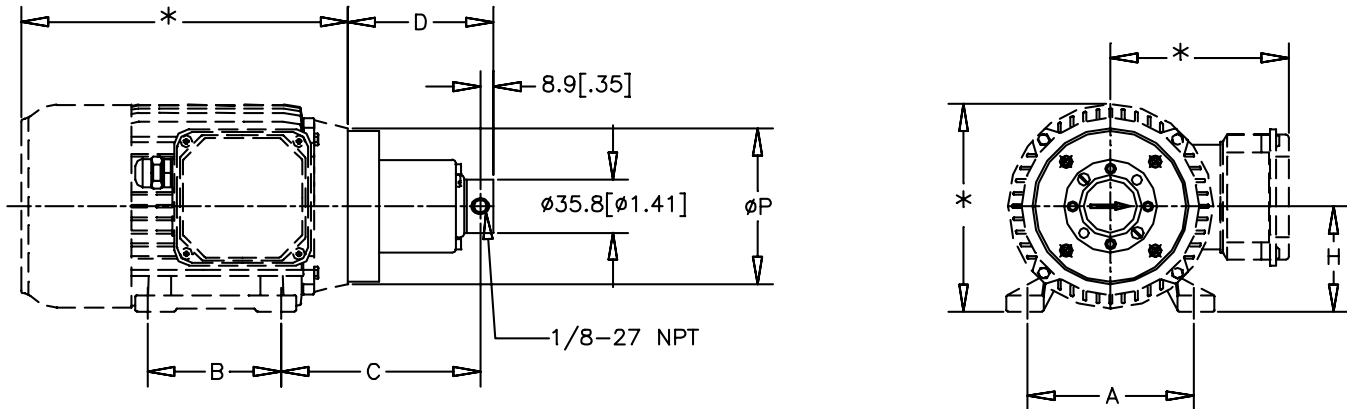

MOUNT	A mm [in]	B mm [in]	C mm [in]	D mm [in]	H mm [in]	P mm [in]
2 IEC56B14B3	90 [3.54]	71 [2.80]	112.4 [4.43]	85.3 [3.36]	56 [2.20]	80 [3.15]
4 IEC63B14B3	100 [3.94]	80 [3.15]	122.0 [4.80]	90.9 [3.58]	63 [2.48]	90 [3.54]
6 IEC71B14B3	112 [4.41]	90 [3.54]	134.1 [5.28]	97.9 [3.86]	71 [2.80]	105 [4.13]

NOTES:

- *THESE DIMENSIONS WILL VARY BASED ON MOTOR SELECTION.
- ALL DIMENSIONS ARE NOMINAL.

ACTUAL PERFORMANCE MAY VARY - Specifications are subject to change without notice. When multiple specs are noted, the most conservative value applies.

MICROPUMP Inc.

4600 NW Camas Meadows Suite 200
Camas, WA 98607 USA
Tel. +1 360-253-2008

www.micropump.com
www.cemegroup.com

Avenida de la Eficiencia #167,
Nuevo Nogales Industrial Park,
Nogales, Sonora, C.P. 84094

Mda Business Park, Irishtown,
Mountmellick, Co. Laois, R32 XYK6, Ireland

VAT GB975036992

Mod. 01 del ./././24

CEME ULKA

AC

MICROPUMP
PROCON

Order Code										Options		
Base Code			Gear Set		Drive Mount							
G	B	-	P25					A				
1	2	3	4	5	6	7	8	O/C: Pump S/K: Service Kit				
Model				Wetted Materials								

Pump Construction	
Magnetic Drive Gear Pump	
Suction Shoe Style	
Two or Three Helical Gears/DP25	
Stationary Shafts	
O-Ring Seal (Qty 1)	

Pump Construction

Magnetic Drive Gear Pump
Suction Shoe Style
Two or Three Helical Gears/DP25
Stationary Shafts
O-Ring Seal (Qty 1)

Dimensions

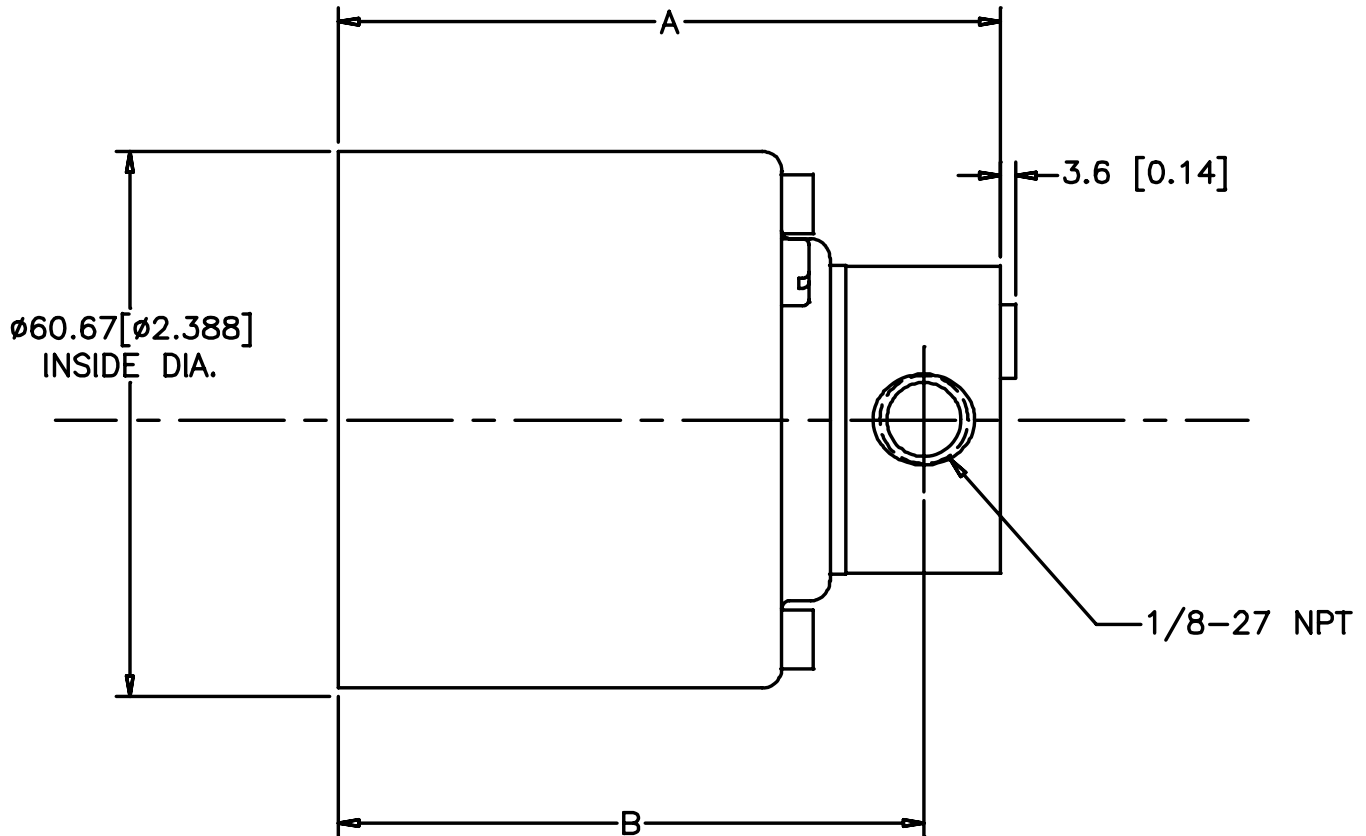

A (MAX) mm [in]	B mm [in]
77.0 [3.03]	68.1 [2.68]

NOTES:

1. ALL DIMENSIONS ARE NOMINAL.

ACTUAL PERFORMANCE MAY VARY - Specifications are subject to change without notice. When multiple specs are noted, the most conservative value applies.

MICROPUMP Inc.

4600 NW Camas Meadows Suite 200
Camas, WA 98607 USA
Tel. +1 360-253-2008

www.micropump.com
www.cemegroup.com

Avenida de la Eficiencia #167,
Nuevo Nogales Industrial Park,
Nogales, Sonora, C.P. 84094

Mda Business Park, Irishtown,
Mountmellick, Co. Laois, R32 XYK6, Ireland

VAT GB975036992

Mod. 01 del ./././24

CEME ULKA

AC

MICROPUMP
PROCON

Order Code										Options	
Base Code			Gear Set			Drive Mount					
G	B	-	P25					E			
1	2	3	4	5	6	7	8				
Model			Wetted Materials			O/C: Pump S/K: Service Kit					

Pump Construction	
Magnetic Drive Gear Pump	
Suction Shoe Style	
Two or Three Helical Gears/DP25	
Stationary Shafts	
O-Ring Seal (Qty 1)	



Pump Construction
 Magnetic Drive Gear Pump
 Suction Shoe Style
 Two or Three Helical Gears/DP25
 Stationary Shafts
 O-Ring Seal (Qty 1)



Dimensions

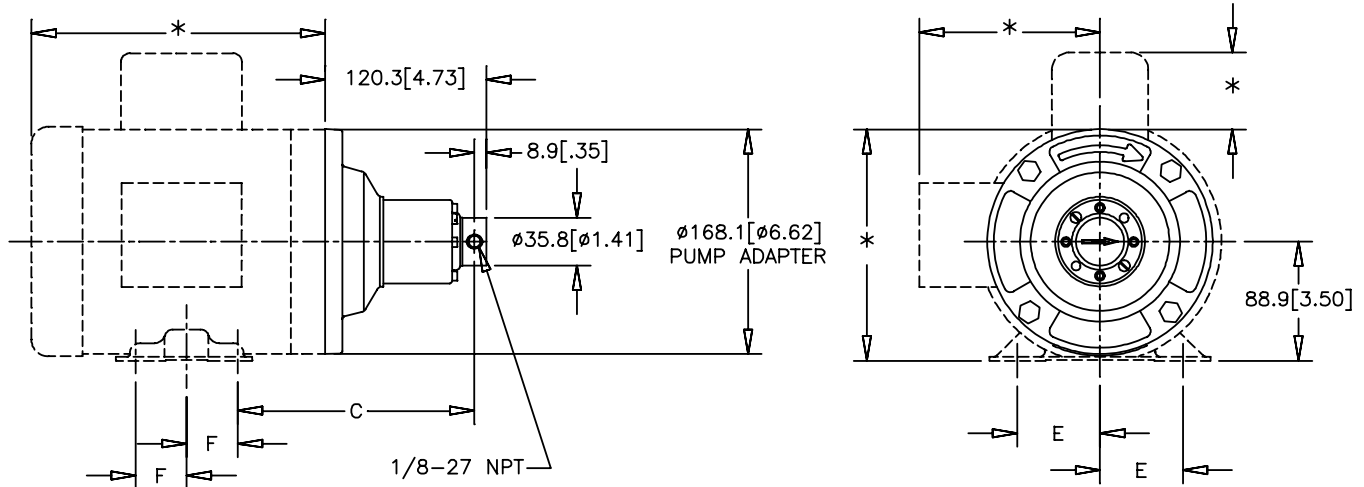

MOUNT	C mm [in]	E mm [in]	F mm [in]
NEMA ^E 56C	176.7 [6.95]	61.9 [2.44]	38.1 [1.50]
NEMA ^K 143TC	171.8 [6.77]	69.9 [2.75]	50.8 [2.00]
NEMA ^K 145TC	171.8 [6.77]	69.9 [2.75]	63.5 [2.50]

NOTES:

- *THESE DIMENSIONS WILL VARY BASED ON MOTOR SELECTION.
- ALL DIMENSIONS ARE NOMINAL.

ACTUAL PERFORMANCE MAY VARY - Specifications are subject to change without notice. When multiple specs are noted, the most conservative value applies.

MICROPUMP Inc.

4600 NW Camas Meadows Suite 200
 Camas, WA 98607 USA
 Tel. +1 360-253-2008

www.micropump.com
 www.cemegroup.com

Avenida de la Eficiencia #167,
 Nuevo Nogales Industrial Park,
 Nogales, Sonora, C.P. 84094

Mda Business Park, Irishtown,
 Mountmellick, Co. Laois, R32 XYK6, Ireland

VAT GB975036992

Mod. 01 del ./././24

CEME ULKA

AC

MICROPUMP
 PROCON

Order Code										Gear Set	Drive Mount			Options	
Base Code															
G	B	-	P35												
1	2	3	4	5	6	7	8								
Model			Wetted Materials				O/C: Pump S/K: Service Kit								

Pump Construction
Magnetic Drive Gear Pump
Suction Shoe Style
Two or Three Helical Gears/DP25
Stationary Shafts
O-Ring Seal (Qty 1)

Pump Construction

Magnetic Drive Gear Pump
Suction Shoe Style
Two or Three Helical Gears/DP25
Stationary Shafts
O-Ring Seal (Qty 1)

Performance

GB-P35

Water @ 1 CP

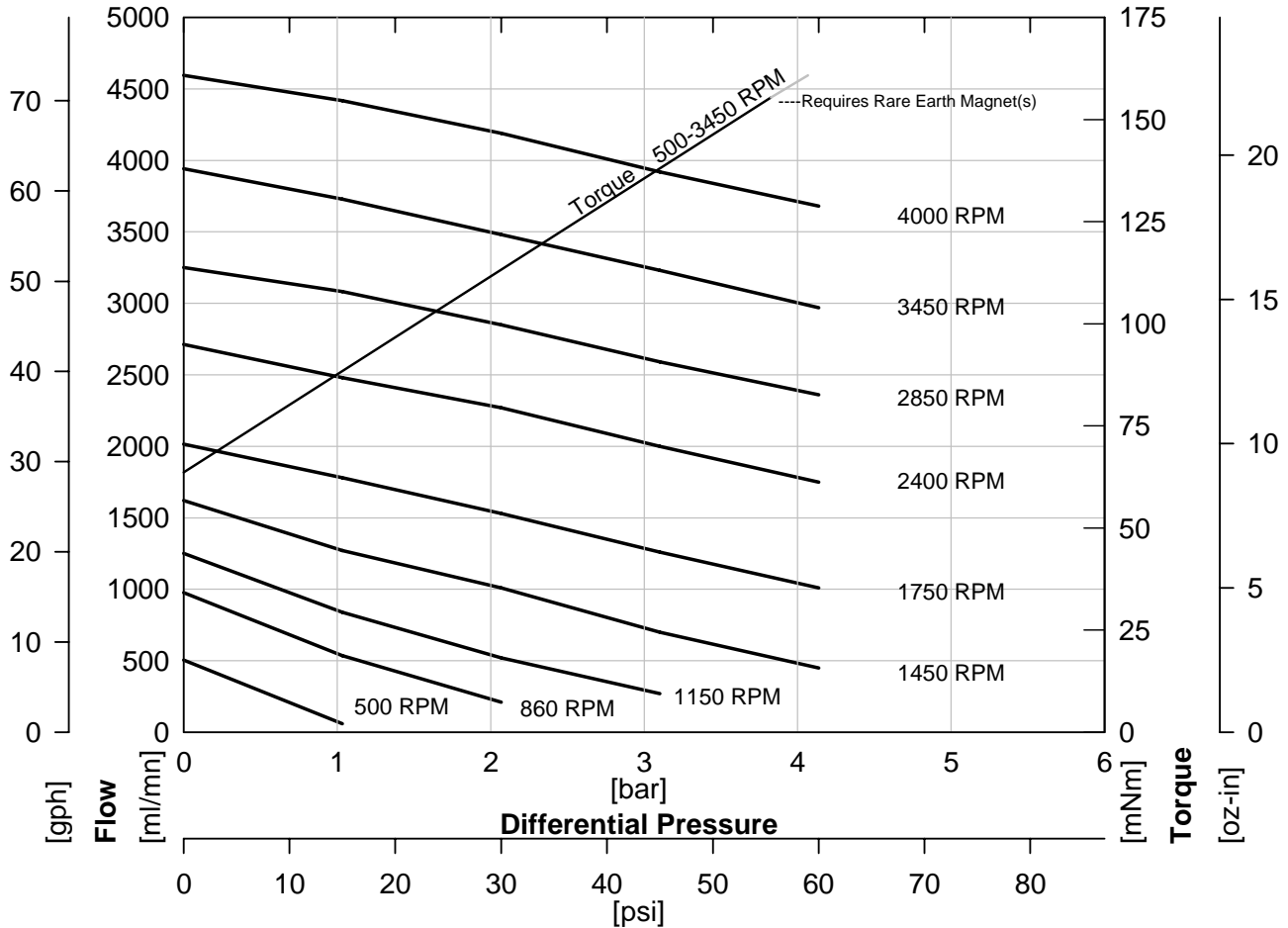

ACTUAL PERFORMANCE MAY VARY - Specifications are subject to change without notice. When multiple specs are noted, the most conservative value applies.

MICROPUMP Inc.

4600 NW Camas Meadows Suite 200
Camas, WA 98607 USA
Tel. +1 360-253-2008

www.micropump.com
www.cemegroup.com

Avenida de la Eficiencia #167,
Nuevo Nogales Industrial Park,
Nogales, Sonora, C.P. 84094

Mda Business Park, Irishtown,
Mountmellick, Co. Laois, R32 XYK6, Ireland

VAT GB975036992

Mod. 01 del -././24

CEME ULKA

AC

MICROPUMP

PROCON

Order Code				Pump Construction																				
Base Code <table border="1"> <tr> <td>G</td> <td>B</td> <td>-</td> <td>P35</td> </tr> <tr> <td>1</td> <td>2</td> <td>3</td> <td>4</td> </tr> </table> Model				G	B	-	P35	1	2	3	4	Gear Set <table border="1"> <tr> <td>5</td> <td>6</td> <td>7</td> <td>8</td> </tr> </table> Wetted Materials				5	6	7	8	Drive Mount <table border="1"> <tr> <td>Options</td> </tr> </table> O/C: Pump S/K: Service Kit				Options
G	B	-	P35																					
1	2	3	4																					
5	6	7	8																					
Options																								
				Magnetic Drive Gear Pump Suction Shoe Style Two or Three Helical Gears/DP25 Stationary Shafts O-Ring Seal (Qty 1)																				



Performance-High Viscosity

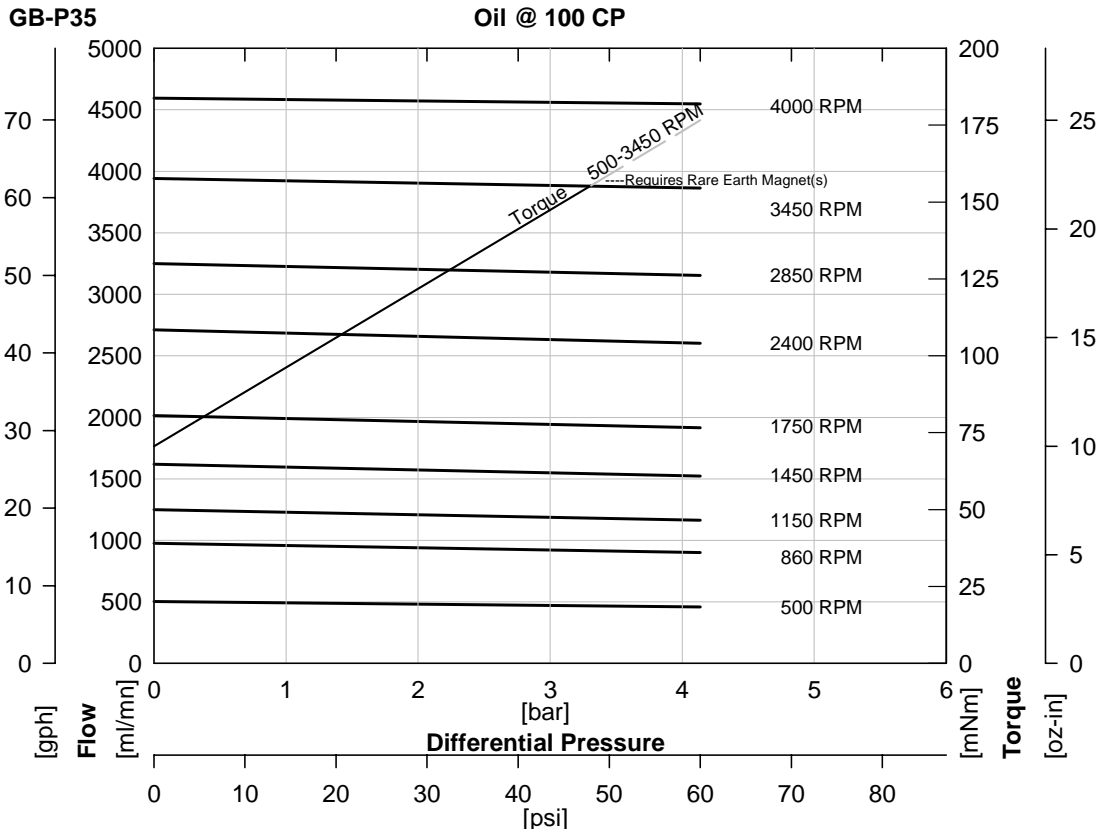

$$\text{Watts} = \frac{\text{Torque [mNm]} \times \text{Speed [RPM]}}{9555}$$

$$\text{HP} = \frac{\text{Torque [oz-in]} \times \text{Speed [RPM]}}{1.008 \times 10^6}$$

To calculate torque, multiply correction factor by torque from viscosity curve above.

Torque Correction Factors: For Higher Viscosity Liquids				
Viscosity [cp]		1	100	1500
Max Speed [RPM]		3450	3450	300
[Bar]	[psi]			
0.3	5	0.9	1	1.2
1.4	20	0.9	1	1.2
2.8	40	0.9	1	1.1
4.1	60	0.9	1	1.1

Magnet Decouple Torque			
Driven Magnet	Driving Hub	Torque [mNm]	Torque [oz.in]
Ferrite	Ferrite	155	22
Ferrite	SmCo	212	30
Ferrite	NdFeB	353	50
SmCo	Ferrite	254	36
SmCo	SmCo	565	80
SmCo	NdFeB	777	110

ACTUAL PERFORMANCE MAY VARY - Specifications are subject to change without notice. When multiple specs are noted, the most conservative value applies.

MICROPUMP Inc.

4600 NW Camas Meadows Suite 200
Camas, WA 98607 USA
Tel. +1 360-253-2008

www.micropump.com
www.cemegroup.com

Avenida de la Eficiencia #167,
Nuevo Nogales Industrial Park,
Nogales, Sonora, C.P. 84094

Mda Business Park, Irishtown,
Mountmellick, Co. Laois, R32 XYK6, Ireland

VAT GB975036992

Mod. 01 del -././24

CEME ULKA

AC

MICROPUMP
PROCON

<u>Order Code</u>								<u>Pump Construction</u>			
Base Code			Gear Set		Drive Mount			Options			Magnetic Drive Gear Pump
G	B	-	P35						Suction Shoe Style		Two or Three Helical Gears/DP25
1	2	3	4	5	6	7	8		Stationary Shafts		O-Ring Seal (Qty 1)
Model			Wetted Materials			O/C: Pump S/K: Service Kit					

Pump Construction

Magnetic Drive Gear Pump
Suction Shoe Style
Two or Three Helical Gears/DP25
Stationary Shafts
O-Ring Seal (Qty 1)

Specifications

	SI	US
Displacement	1.17 ml/rev	0.31 gal/1000*rev
Max Flow (4 Pole Speed)	1700 ml/mn 1450 RPM (50Hz)	33 gal/hr 1750 RPM (60Hz)
Max Flow (2 Pole Speed)	3340 ml/mn 2850 RPM (50Hz)	1.1 gal/mn 3450 RPM (60Hz)
Max Differential Pressure	4.2 Bar	60 psi
Max System Pressure (MAWP)	21 Bar	300 psi
NIPR (Absolute)	180 mBar	2.5 psia
Wet Lift (Typical)	51 cm.H ₂ O (1450 RPM)	24 in.H ₂ O (1750 RPM)
Temp Range	See Gear Material	See Gear Material
Viscosity Range	0.2 to 1500 cp	0.2 to 1500 cp
Max Speed	10,000 RPM	10,000 RPM
Rotation (Facing Motor Shaft)	CW	CW
Weight (Pumphead)	0.34 kg	0.75 lbs
Dimensions (LxWxH)	See Drawing	See Drawing
Ports	1/8-27 (F) NPT Side Ports	1/8-27 (F) NPT Side Ports
Driven Magnet (Standard)	Ferrite	Ferrite
Optional Internal Bypass	Preset to 3 Bar (pump only)	Preset to 45 psi (pump only)

Notes

- See Product Options. Max pressure depends on gear material.
- Priming ability varies with operating conditions.
- See Product Options for specific temp limits.
- See Performance-High Viscosity for viscosity limits.

ACTUAL PERFORMANCE MAY VARY - Specifications are subject to change without notice. When multiple specs are noted, the most conservative value applies.

MICROPUMP Inc.

4600 NW Camas Meadows Suite 200
Camas, WA 98607 USA
Tel. +1 360-253-2008

www.micropump.com
www.cemegroup.com

Avenida de la Eficiencia #167,
Nuevo Nogales Industrial Park,
Nogales, Sonora, C.P. 84094

Mda Business Park, Irishtown,
Mountmellick, Co. Laois, R32 XYK6, Ireland

VAT GB975036992

Mod. 01 del ././24

CEME ULKA

AC

MICROPUMP

PROCON

Order Code								Options		
Base Code			Gear Set		Drive Mount					
G	B	-	P35				2/4/6			
1	2	3	4	5	6	7	8			
Model			Wetted Materials					O/C: Pump S/K: Service Kit		

Pump Construction	
Magnetic Drive Gear Pump	
Suction Shoe Style	
Two or Three Helical Gears/DP25	
Stationary Shafts	
O-Ring Seal (Qty 1)	

Pump Construction

Magnetic Drive Gear Pump
Suction Shoe Style
Two or Three Helical Gears/DP25
Stationary Shafts
O-Ring Seal (Qty 1)

Dimensions

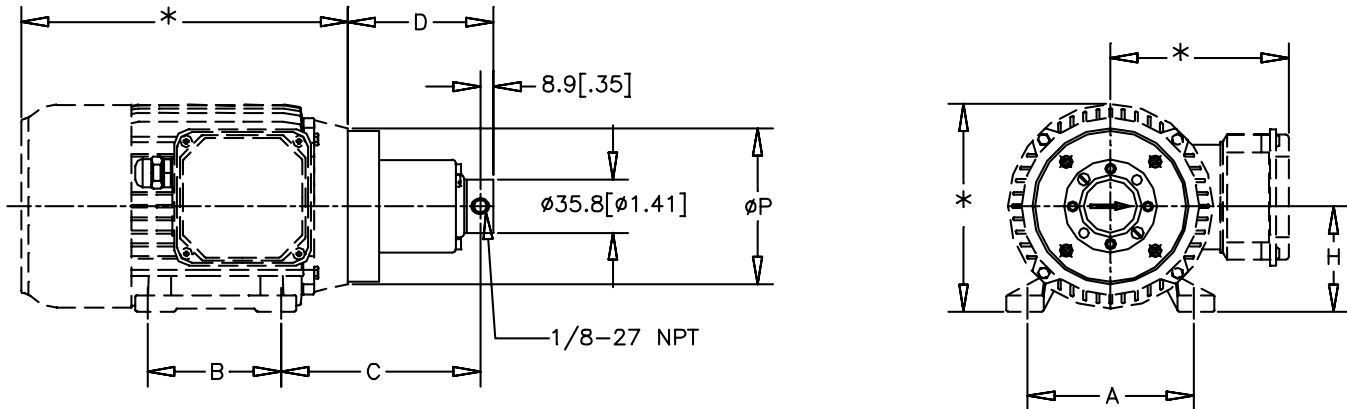

MOUNT	A mm [in]	B mm [in]	C mm [in]	D mm [in]	H mm [in]	P mm [in]
² IEC56B14B3	90 [3.54]	71 [2.80]	112.4 [4.43]	85.3 [3.36]	56 [2.20]	80 [3.15]
⁴ IEC63B14B3	100 [3.94]	80 [3.15]	122.0 [4.80]	90.9 [3.58]	63 [2.48]	90 [3.54]
⁶ IEC71B14B3	112 [4.41]	90 [3.54]	134.1 [5.28]	97.9 [3.86]	71 [2.80]	105 [4.13]

NOTES:

- *THESE DIMENSIONS WILL VARY BASED ON MOTOR SELECTION.
- ALL DIMENSIONS ARE NOMINAL.

ACTUAL PERFORMANCE MAY VARY - Specifications are subject to change without notice. When multiple specs are noted, the most conservative value applies.

MICROPUMP Inc.

4600 NW Camas Meadows Suite 200
Camas, WA 98607 USA
Tel. +1 360-253-2008

www.micropump.com
www.cemegroup.com

Avenida de la Eficiencia #167,
Nuevo Nogales Industrial Park,
Nogales, Sonora, C.P. 84094

Mda Business Park, Irishtown,
Mountmellick, Co. Laois, R32 XYK6, Ireland

VAT GB975036992

Mod. 01 del ./././24

CEME ULKA

AC

MICROPUMP

PROCON

Order Code										Options			
Base Code			Gear Set		Drive Mount								
G	B	-	P35				A						
1	2	3	4	5	6	7	8						
Model			Wetted Materials										
O/C: Pump S/K: Service Kit													

Pump Construction	
Magnetic Drive Gear Pump	
Suction Shoe Style	
Two or Three Helical Gears/DP25	
Stationary Shafts	
O-Ring Seal (Qty 1)	

Pump Construction

Magnetic Drive Gear Pump
Suction Shoe Style
Two or Three Helical Gears/DP25
Stationary Shafts
O-Ring Seal (Qty 1)

Dimensions

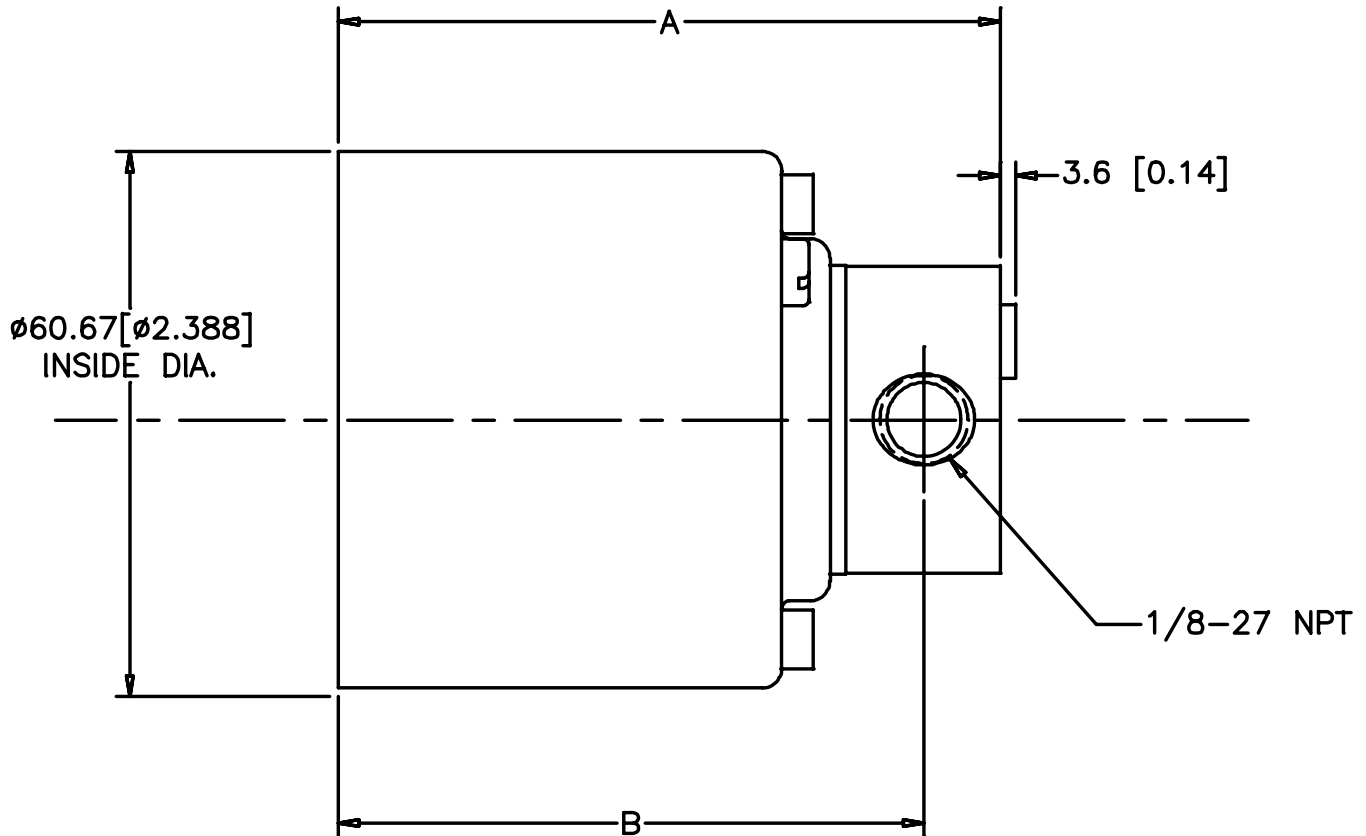

A (MAX) mm [in]	B mm [in]
77.0 [3.03]	68.1 [2.68]

NOTES:

1. ALL DIMENSIONS ARE NOMINAL.

ACTUAL PERFORMANCE MAY VARY - Specifications are subject to change without notice. When multiple specs are noted, the most conservative value applies.

MICROPUMP Inc.

4600 NW Camas Meadows Suite 200
Camas, WA 98607 USA
Tel. +1 360-253-2008

www.micropump.com
www.cemegroup.com

Avenida de la Eficiencia #167,
Nuevo Nogales Industrial Park,
Nogales, Sonora, C.P. 84094

Mda Business Park, Irishtown,
Mountmellick, Co. Laois, R32 XYK6, Ireland

VAT GB975036992

Mod. 01 del ./././24

CEME ULKA

AC

MICROPUMP
PROCON

<u>Order Code</u>										<u>Pump Construction</u>	
Base Code			Gear Set		Drive Mount			Options		Magnetic Drive Gear Pump	
G	B	-	P35				E		Suction Shoe Style	Two or Three Helical Gears/DP25	
1	2	3	4	5	6	7	8		Stationary Shafts	O-Ring Seal (Qty 1)	
Model			Wetted Materials					O/C: Pump S/K: Service Kit			

Pump Construction
 Magnetic Drive Gear Pump
 Suction Shoe Style
 Two or Three Helical Gears/DP25
 Stationary Shafts
 O-Ring Seal (Qty 1)

Dimensions

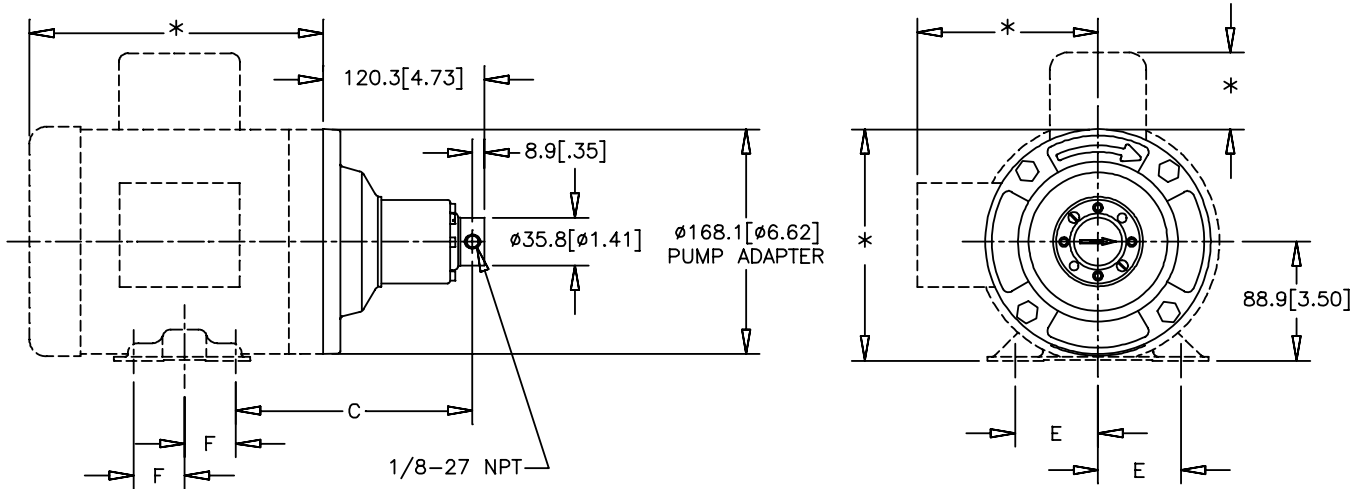

MOUNT	C mm [in]	E mm [in]	F mm [in]
NEMA ^E 56C	176.7 [6.95]	61.9 [2.44]	38.1 [1.50]
NEMA ^K 143TC	171.8 [6.77]	69.9 [2.75]	50.8 [2.00]
NEMA ^K 145TC	171.8 [6.77]	69.9 [2.75]	63.5 [2.50]

NOTES:

- *THESE DIMENSIONS WILL VARY BASED ON MOTOR SELECTION.
- ALL DIMENSIONS ARE NOMINAL.

ACTUAL PERFORMANCE MAY VARY - Specifications are subject to change without notice. When multiple specs are noted, the most conservative value applies.