

<u>Order Code</u>								<u>Pump Construction</u>			
Base Code			Gear Set		Drive Mount			Options			
G	D	-	M35								
1	2	3	4	5	6	7	8				
Model			Wetted Materials								
										O/C: Pump	
										S/K: Service Kit	
								Magnetic Drive Gear Pump			
								Cavity Style			
								Three Helical Gears/DP20			
								Stationary Shafts			
								O-Ring Seal (Qty 1)			

Product Options

Base Code		Select a code character for each numbered position to configure the product.				
1	Code	Product Type	Specifications			Notes
	G	Gear Pump				
2		Product Series	Max System Pressure (MAWP)	Ports		
	D	Series GD	See Drive Mount	3/8-18 (F) NPT Side Ports		
3		Modifier				
	-	Standard Design				
4		Gear Set (Width/N°Gears/Pitch)	Displacement	Max Differential Pressure	Driven Magnet (Standard)	
	M35	0.750/3/20	3.48 ml/rev (0.92 gal/1000*rev)	6.9 Bar (100 psi)	Ferrite	
5		Gear Material		Max Differential Pressure	Temp Range	
	2	TOOL STEEL		5.2 Bar (75 psi)	-46/260°C (-50/500°F)	1
	J	PEEK (carbon fiber/ptfe)		8.7 Bar (125 psi)	-46/121°C (-50/250°F)	
	P	PPS (carbon fiber/ptfe)		5.2 Bar (75 psi)	-46/121°C (-50/250°F)	
6		Static Seals				Temp Range
	V	Viton®				-29/204°C (-20/400°F)
	D	EP				-46/149°C (-50/300°F)
	K	Kalrez®				-29/260°C (-20/500°F)
	F5	TEV (PTFE encap Viton®)				-29/204°C (-20/400°F)
7		Base Materials				
	C	Hast C-276®				
	D	Alloy 20				
	S	SS316				
	T	Titanium				
8		Drive Mount	Max System Pressure (MAWP)	Weight (Pumphead)		
	E	NEMA 56C/143/145TC	103 Bar (1500 psi)	2.7 kg (6.0 lbs)		
	F	MICROPUMP F-MOUNT	103 Bar (1500 psi)	1.7 kg (3.7 lbs)		
	4-8	IEC 63-B14 - IEC 80-B14	103 Bar (1500 psi)	2.7 kg (6.0 lbs)		

Options		Add Option codes after the Base Code to modify features or enhance the product.	
	Driven Magnet (PC12)		Temp Range
M1	SmCo Driven (Segments)		-46/260°C (-50/500°F)
M3	NdFeB Driven (Ring)		-46/82°C (-50/180°F)
	Driving Magnet (PC13)		Temp Range
N0	Ferrite Driving (Ring)		-46/99°C (-50/210°F)
N1	SmCo Driving (Segments)		-46/260°C (-50/500°F)
N3	NdFeB Driving (Ring)		-46/82°C (-50/180°F)

Notes

- 1 Available only with Hybrid/Abrasive Modifier PC3 "RV"

ACTUAL PERFORMANCE MAY VARY - Specifications are subject to change without notice. When multiple specs are noted, the most conservative value applies.

MICROPUMP Inc.

4600 NW Camas Meadows Suite 200
Camas, WA 98607 USA
Tel. +1 360-253-2008

www.micropump.com
www.cemegroup.com

Avenida de la Eficiencia #167,
Nuevo Nogales Industrial Park,
Nogales, Sonora, C.P. 84094

Mdja Business Park, Irishtown,
Mountmellick, Co. Laois, R32 XYK6, Ireland

VAT GB975036992

Mod. 01 del ./. /24

CEME ULKA

AC

MICROPUMP

PROCON

<u>Order Code</u>										<u>Pump Construction</u>	
Base Code			Gear Set		Drive Mount			Options			
G	D	-	M35								
1	2	3	4	5	6	7	8				
Model			Wetted Materials								
									O/C: Pump S/K: Service Kit		
										Magnetic Drive Gear Pump Cavity Style Three Helical Gears/DP20 Stationary Shafts O-Ring Seal (Qty 1)	

Pump Construction
 Magnetic Drive Gear Pump
 Cavity Style
 Three Helical Gears/DP20
 Stationary Shafts
 O-Ring Seal (Qty 1)



Performance

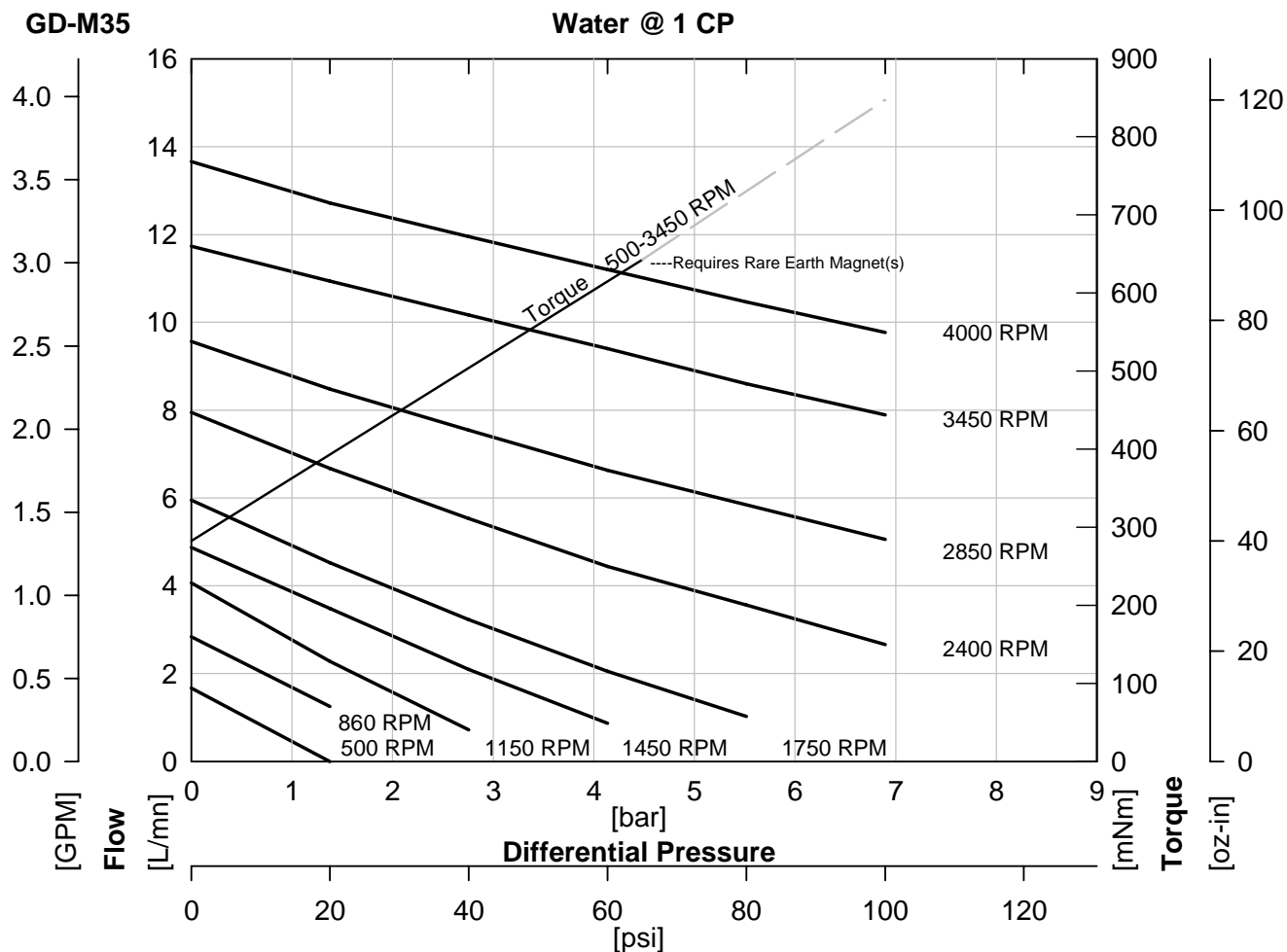

ACTUAL PERFORMANCE MAY VARY - Specifications are subject to change without notice. When multiple specs are noted, the most conservative value applies.

MICROPUMP Inc.

4600 NW Camas Meadows Suite 200
 Camas, WA 98607 USA
 Tel. +1 360-253-2008

www.micropump.com
 www.cemegroup.com

Avenida de la Eficiencia #167,
 Nuevo Nogales Industrial Park,
 Nogales, Sonora, C.P. 84094

Mdga Business Park, Irishtown,
 Mountmellick, Co. Laois, R32 XYK6, Ireland

VAT GB975036992
 Mod. 01 del ././24

CEME ULKA

AC

MICROPUMP

PROCON

Order Code										Pump Construction
Base Code			Gear Set		Drive Mount		Options			 <p> Magnetic Drive Gear Pump Cavity Style Three Helical Gears/DP20 Stationary Shafts O-Ring Seal (Qty 1) </p>
G	D	-	M35							
1	2	3	4	5	6	7	8			
Model			Wetted Materials			O/C: Pump S/K: Service Kit				

Performance-High Viscosity

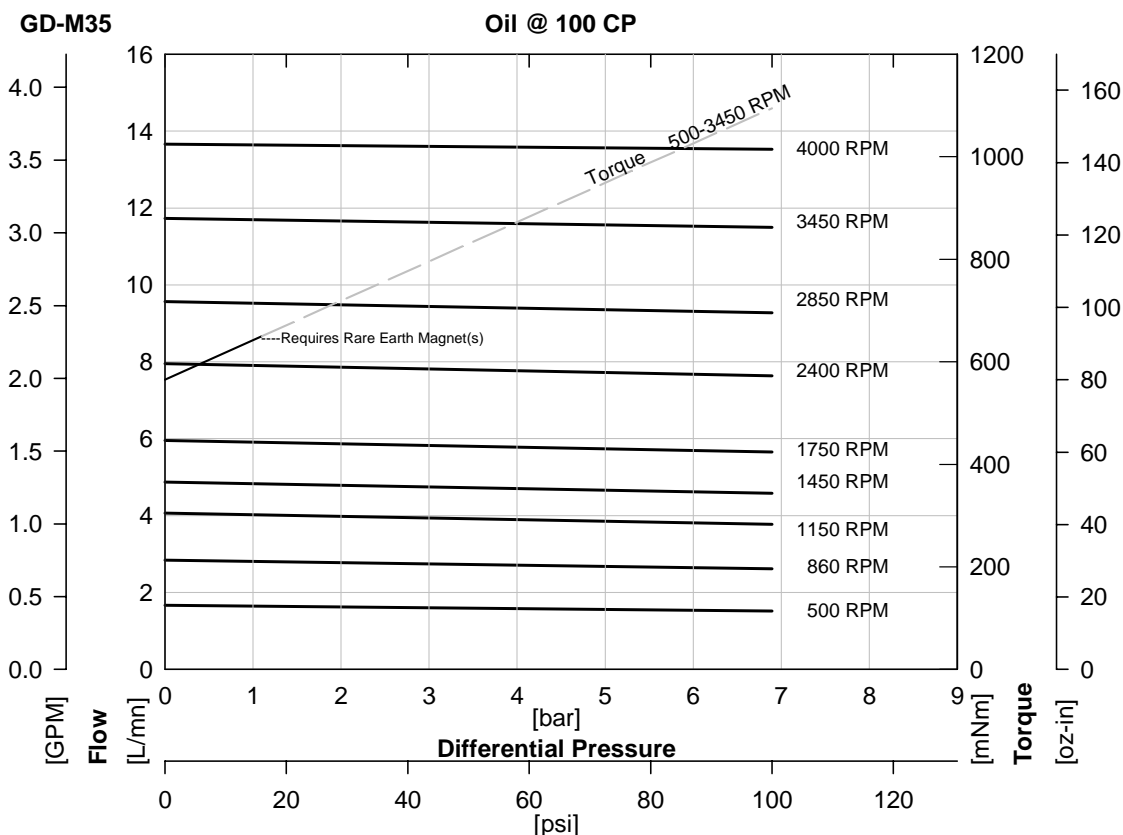

$$\text{Watts} = \frac{\text{Torque [mNm]} \times \text{Speed [RPM]}}{9555}$$

$$\text{HP} = \frac{\text{Torque [oz-in]} \times \text{Speed [RPM]}}{1.008 \times 10^6}$$

To calculate torque, multiply correction factor by torque from viscosity curve above.

Torque Correction Factors: For Higher Viscosity Liquids				
Viscosity [cp]		1	100	1500
Max Speed [RPM]		3450	3450	200
[Bar]	[psi]			
0.3	5	0.5	1	0.8
1.4	20	0.6	1	0.8
2.8	40	0.6	1	0.9
4.1	60	0.7	1	0.9
5.5	80	0.7	1	0.9
6.9	100	0.8	1	1.0

Magnet Decouple Torque			
Driven Magnet	Driving Hub	Torque [mNm]	Torque [oz.in]
Ferrite	Ferrite	643	91
Ferrite	SmCo	819	116
Ferrite	NdFeB	1073	152
SmCo	Ferrite	1222	173
SmCo	SmCo	1483	210
SmCo	NdFeB	1780	252

ACTUAL PERFORMANCE MAY VARY - Specifications are subject to change without notice. When multiple specs are noted, the most conservative value applies.

MICROPUMP Inc.

4600 NW Camas Meadows Suite 200
Camas, WA 98607 USA
Tel. +1 360-253-2008

www.micropump.com
www.cemegroup.com

Avenida de la Eficiencia #167,
Nuevo Nogales Industrial Park,
Nogales, Sonora, C.P. 84094

Mda Business Park, Irishtown,
Mountmellick, Co. Laois, R32 YXK6, Ireland

VAT GB975036992

Mod. 01 del ./. /24

CEME ULKA

AC

MICROPUMP

PROCON

<u>Order Code</u>								<u>Pump Construction</u>		
Base Code		Gear Set		Drive Mount		Options		Magnetic Drive Gear Pump		
G	D	-	M35					Cavity Style		
1	2	3	4	5	6	7	8	Three Helical Gears/DP20		
Model			Wetted Materials			O/C: Pump S/K: Service Kit		Stationary Shafts		
								O-Ring Seal (Qty 1)		

Pump Construction
Magnetic Drive Gear Pump
Cavity Style
Three Helical Gears/DP20
Stationary Shafts
O-Ring Seal (Qty 1)

Specifications

	SI	US
Displacement	3.48 ml/rev	0.92 gal/1000*rev
Max Flow (4 Pole Speed)	5.1 L/mn 1450 RPM (50Hz)	1.7 gal/mn 1750 RPM (60Hz)
Max Flow (2 Pole Speed)	10.0 L/mn 2850 RPM (50Hz)	3.2 gal/mn 3450 RPM (60Hz)
Max Differential Pressure	1 6.9 Bar	100 psi
Max System Pressure (MAWP)	See Drive Mount	See Drive Mount
NIPR (Absolute)	180 mBar	2.5 psia
Wet Lift (Typical)	2 51 cm.H ₂ O (1450 RPM)	24 in.H ₂ O (1750 RPM)
Temp Range	3 See Gear Material	See Gear Material
Viscosity Range	4 0.2 to 1500 cp	0.2 to 1500 cp
Max Speed	4,000 RPM	4,000 RPM
Rotation (Facing Motor Shaft)	CW	CW
Weight (Pumphead)	1.7 kg	3.7 lbs
Dimensions (LxWxH)	See Drawing	See Drawing
Ports	3/8-18 (F) NPT Side Ports	3/8-18 (F) NPT Side Ports
Driven Magnet (Standard)	Ferrite	Ferrite
Optional Internal Bypass	No	No

Notes

- 1 See Product Options. Max pressure depends on gear material.
- 2 Priming ability varies with operating conditions.
- 3 See Product Options for specific temp limits.
- 4 See Performance-High Viscosity for viscosity limits.

ACTUAL PERFORMANCE MAY VARY - Specifications are subject to change without notice. When multiple specs are noted, the most conservative value applies.

MICROPUMP Inc.

4600 NW Camas Meadows Suite 200
Camas, WA 98607 USA
Tel. +1 360-253-2008

www.micropump.com
www.cemegroup.com

Avenida de la Eficiencia #167,
Nuevo Nogales Industrial Park,
Nogales, Sonora, C.P. 84094

Mdga Business Park, Irishtown,
Mountmellick, Co. Laois, R32 XYK6, Ireland

VAT GB975036992

Mod. 01 del -/./24

CEME ULKA

AC

MICROPUMP

PROCON

Order Code								Options		
Base Code			Gear Set		Drive Mount					
G	D	-	M35				4/6			
1	2	3	4	5	6	7	8			
Model			Wetted Materials					O/C: Pump S/K: Service Kit		

Pump Construction	
Magnetic Drive Gear Pump	
Cavity Style	
Three Helical Gears/DP20	
Stationary Shafts	
O-Ring Seal (Qty 1)	

Pump Construction
 Magnetic Drive Gear Pump
 Cavity Style
 Three Helical Gears/DP20
 Stationary Shafts
 O-Ring Seal (Qty 1)

Dimensions

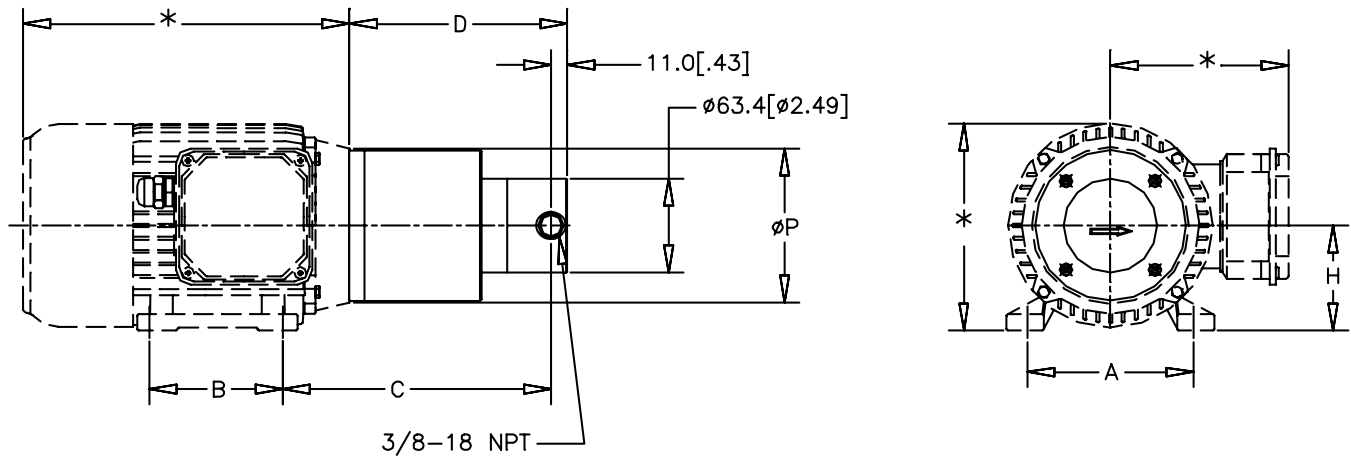

PUMP	MOUNT	A mm [in]	B mm [in]	C mm [in]	D mm [in]	H mm [in]	P mm [in]
GD-M35	4 IEC63B14B3	100 [3.94]	80 [3.15]	168.9 [6.65]	139.9 [5.51]	63 [2.48]	90 [3.54]
	6 IEC71B14B3	112 [4.41]	90 [3.54]	180.9 [7.12]	139.9 [5.51]	71 [2.80]	105 [4.13]

NOTES:

- *THESE DIMENSIONS WILL VARY BASED ON MOTOR SELECTION.
- ALL DIMENSIONS ARE NOMINAL.

ACTUAL PERFORMANCE MAY VARY - Specifications are subject to change without notice. When multiple specs are noted, the most conservative value applies.

MICROPUMP Inc.

4600 NW Camas Meadows Suite 200
 Camas, WA 98607 USA
 Tel. +1 360-253-2008

www.micropump.com
 www.cemegroup.com

Avenida de la Eficiencia #167,
 Nuevo Nogales Industrial Park,
 Nogales, Sonora, C.P. 84094

Mdga Business Park, Irishtown,
 Mountmellick, Co. Laois, R32 XYK6, Ireland

VAT GB975036992
 Mod. 01 del ././24

CEME ULKA

AC

MICROPUMP

PROCON

<u>Order Code</u>								<u>Pump Construction</u>			
Base Code			Gear Set		Drive Mount			Options			Magnetic Drive Gear Pump
G	D	-	M35				E				Cavity Style
1	2	3	4	5	6	7	8				Three Helical Gears/DP20
Model			Wetted Materials						O/C: Pump S/K: Service Kit		Stationary Shafts
										O-Ring Seal (Qty 1)	

Pump Construction
 Magnetic Drive Gear Pump
 Cavity Style
 Three Helical Gears/DP20
 Stationary Shafts
 O-Ring Seal (Qty 1)

Dimensions

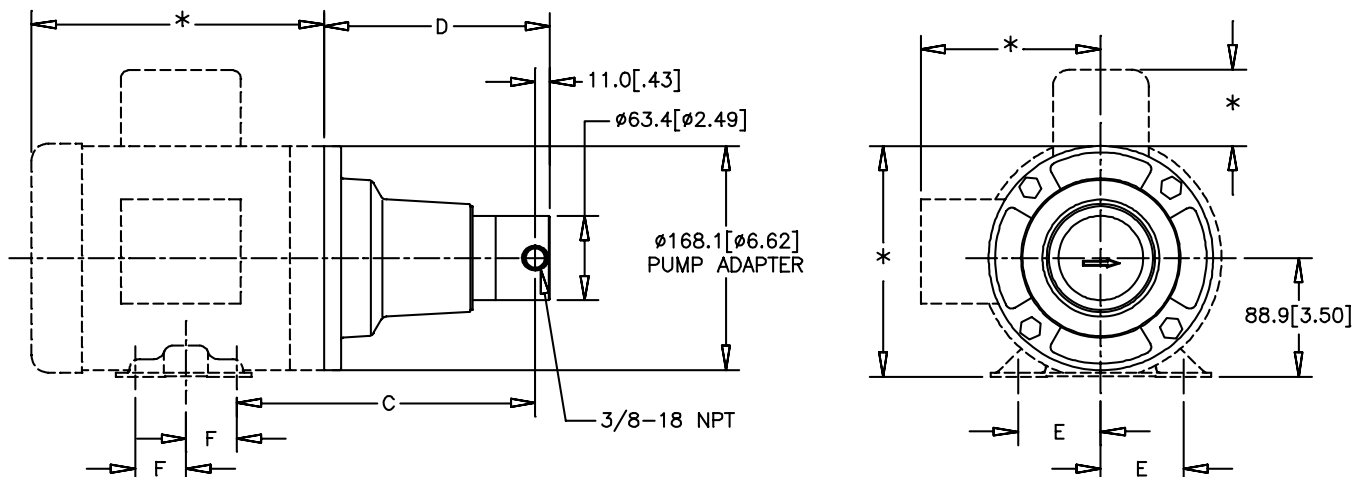

PUMP	MOUNT	C mm [in]	D mm [in]	E mm [in]	F mm [in]
GC-M23	E NEMA 56C	206.4 [8.13]	152.1 [5.99]	61.9 [2.44]	38.1 [1.50]
	K	201.5 [7.94]	152.1 [5.99]	69.9 [2.75]	50.8 [2.00]
	K NEMA 145TC	201.5 [7.94]	152.1 [5.99]	69.9 [2.75]	63.5 [2.50]
GC-M25/M35 GD-M35	E NEMA 56C	223.5 [8.80]	169.2 [6.66]	61.9 [2.44]	38.1 [1.50]
	K NEMA 143TC	218.7 [8.61]	169.2 [6.66]	69.9 [2.75]	50.8 [2.00]
	K NEMA 145TC	218.7 [8.61]	169.2 [6.66]	69.9 [2.75]	63.5 [2.50]

NOTES:

- *THESE DIMENSIONS WILL VARY BASED ON MOTOR SELECTION.
- ALL DIMENSIONS ARE NOMINAL.

ACTUAL PERFORMANCE MAY VARY - Specifications are subject to change without notice. When multiple specs are noted, the most conservative value applies.

MICROPUMP Inc.

4600 NW Camas Meadows Suite 200
 Camas, WA 98607 USA
 Tel. +1 360-253-2008

www.micropump.com
 www.cemegroup.com

Avenida de la Eficiencia #167,
 Nuevo Nogales Industrial Park,
 Nogales, Sonora, C.P. 84094

Mdga Business Park, Irishtown,
 Mountmellick, Co. Laois, R32 XYK6, Ireland

VAT GB975036992

Mod. 01 del ././24

CEME ULKA

AC

MICROPUMP

PROCON